

HEXBUG  
赫比

VEX  
ROBOTICS

机器人套装



斯坦比怪兽

说明书

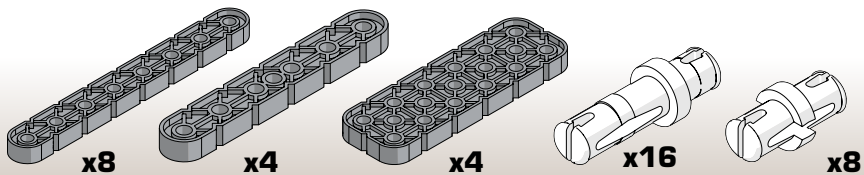

1

4x

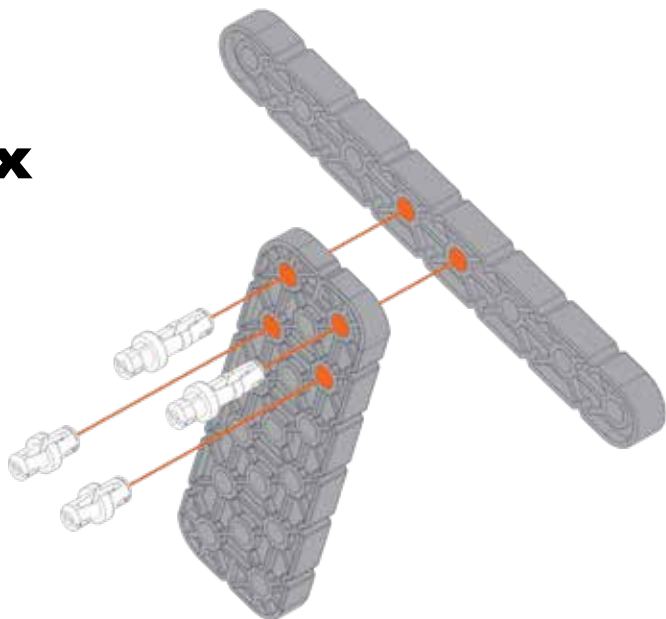

2

4x

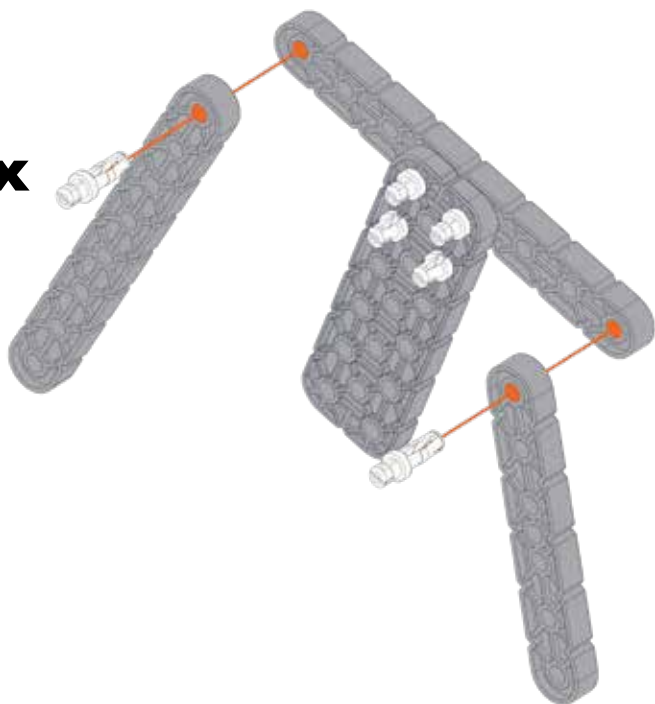

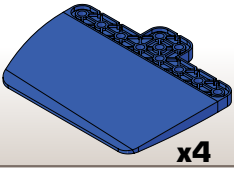

x4

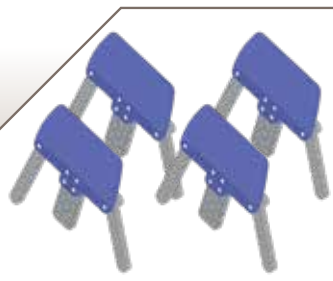

3

4x

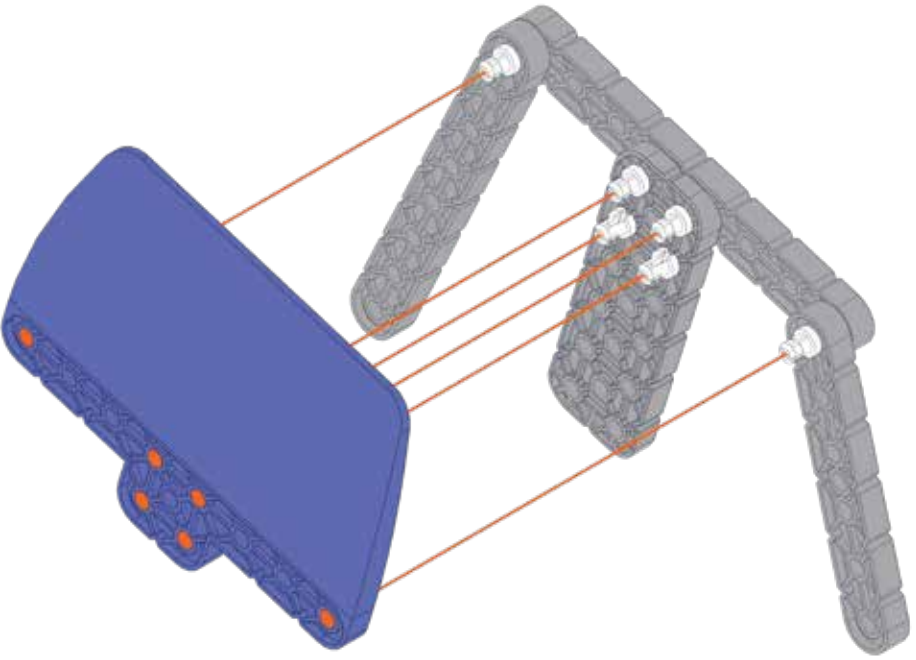

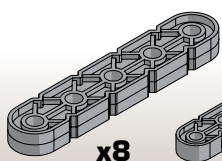

x8

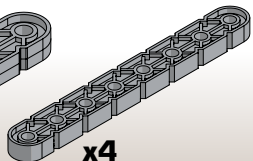

x4

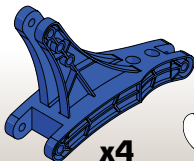

x4

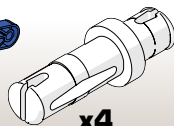

x4

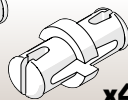

x4

4

4x



5

4x



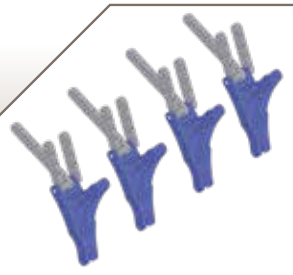

6

4x

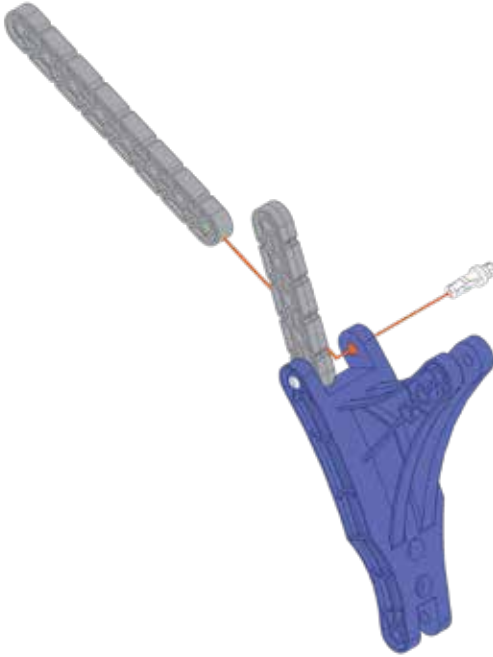

7

4x

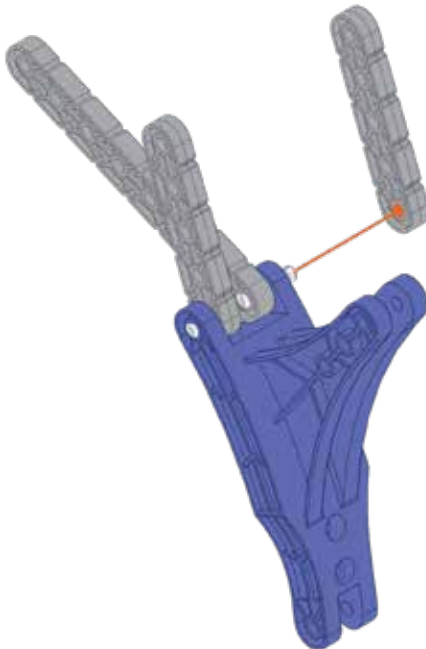

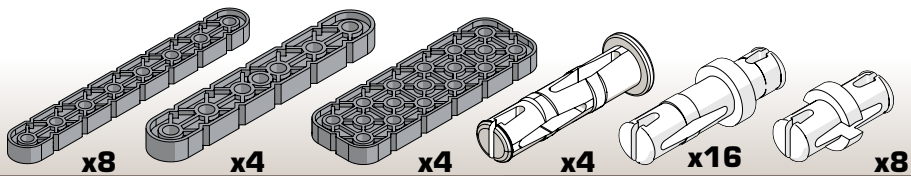

8

4x

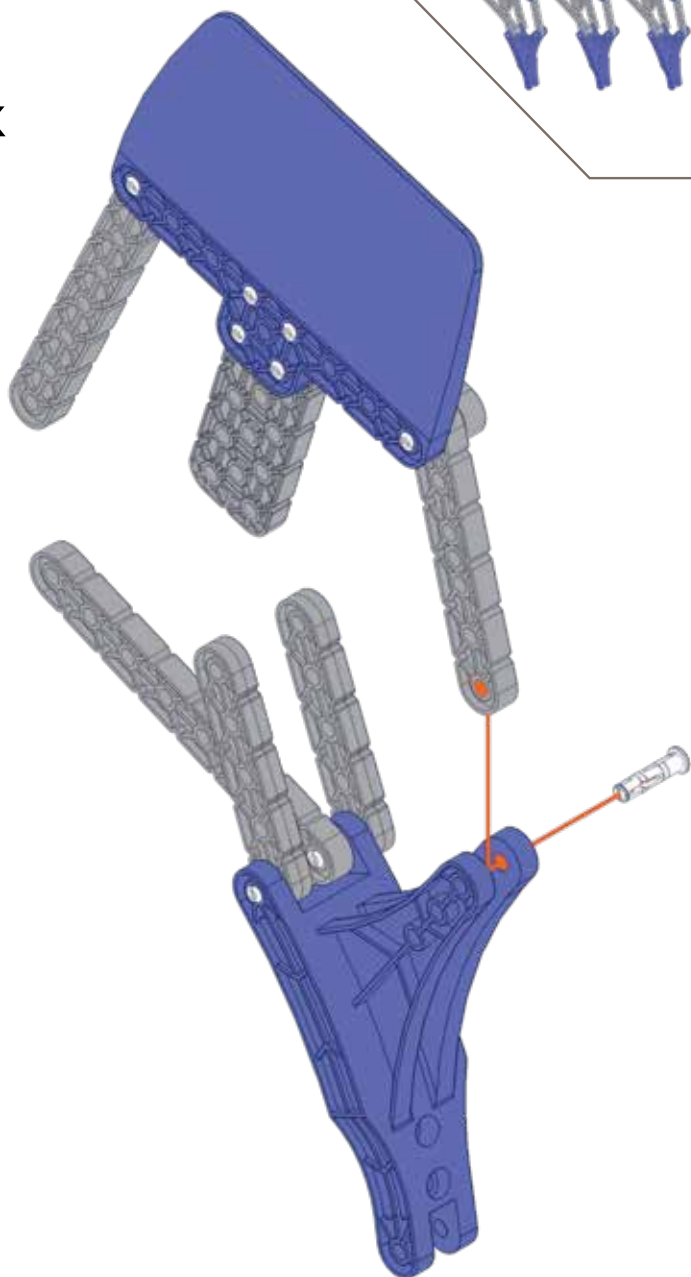
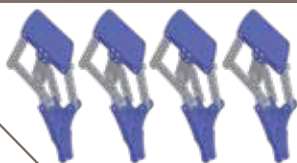

9

4x

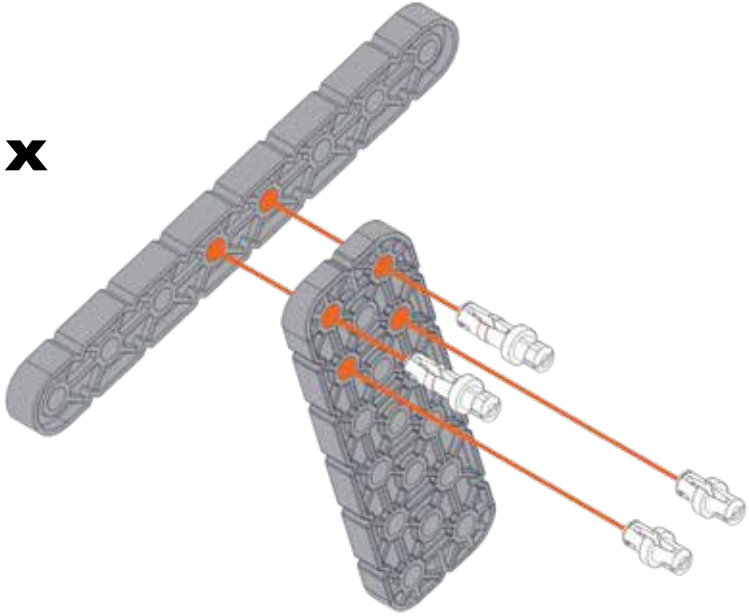

10

4x

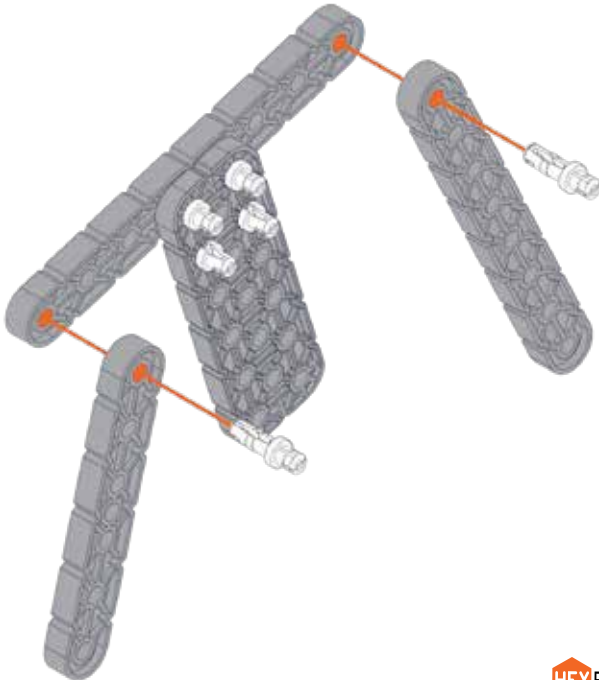

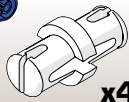
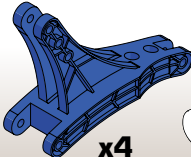
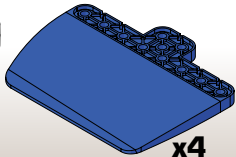
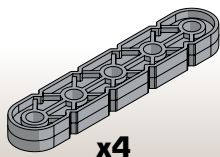

11

4x

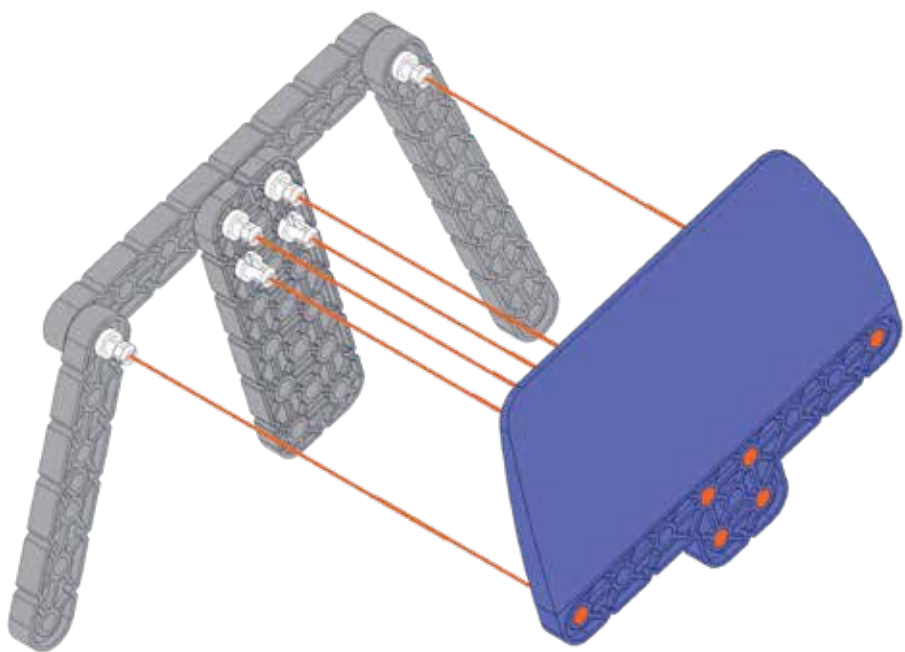
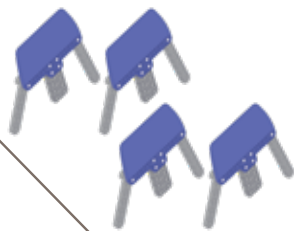





12

4x

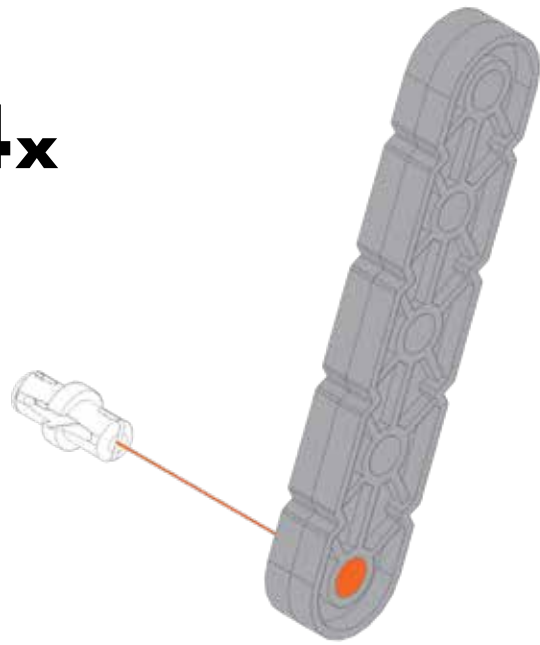

13

4x



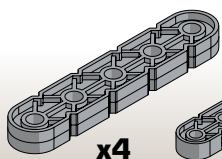

x4

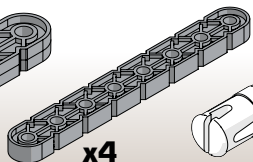

x4

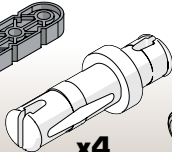

x4

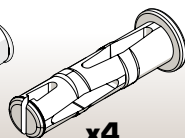

x4

14

4x

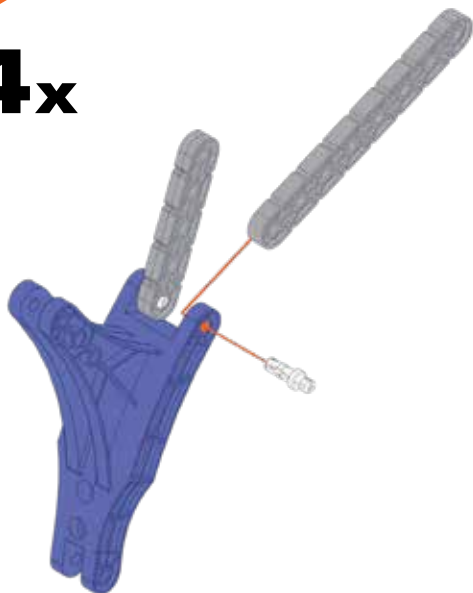

15

4x

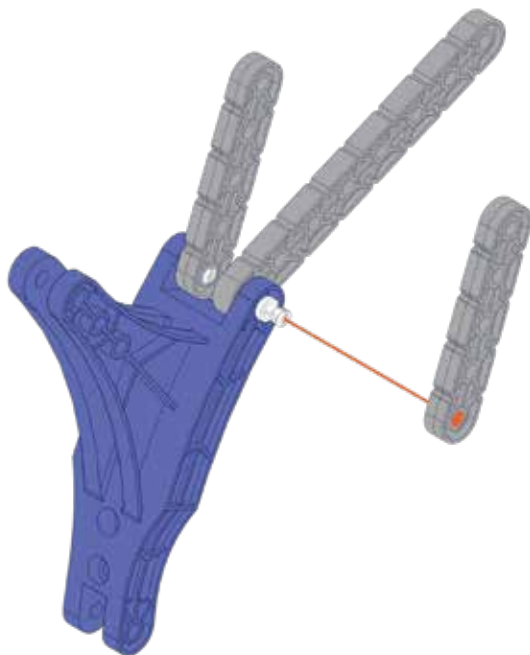

16

4x

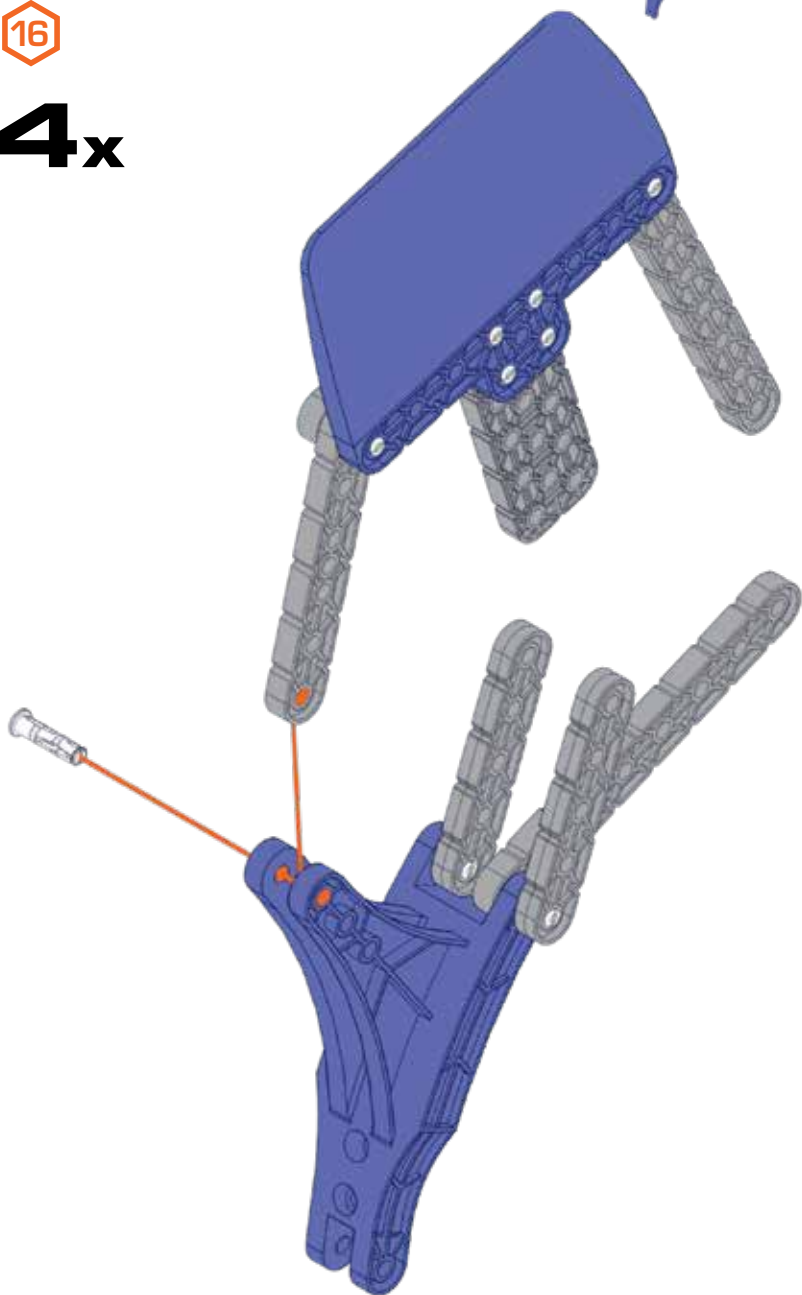
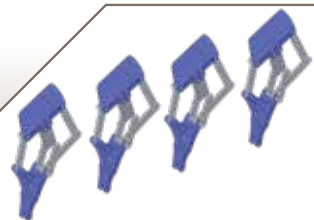

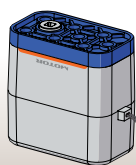

x2

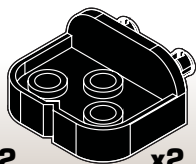

x2



x4

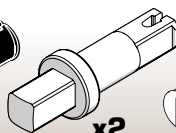

x2

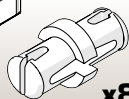

x8

17

2x

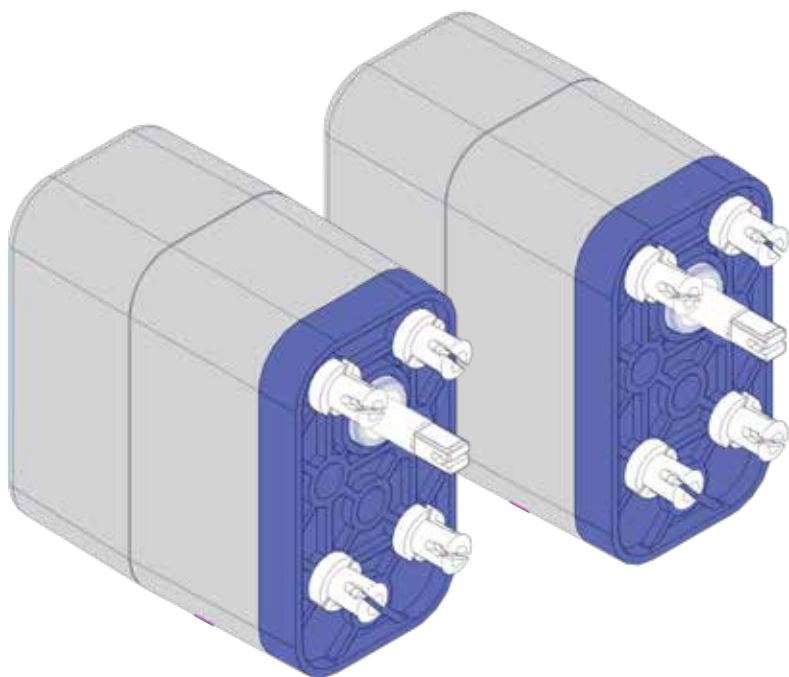
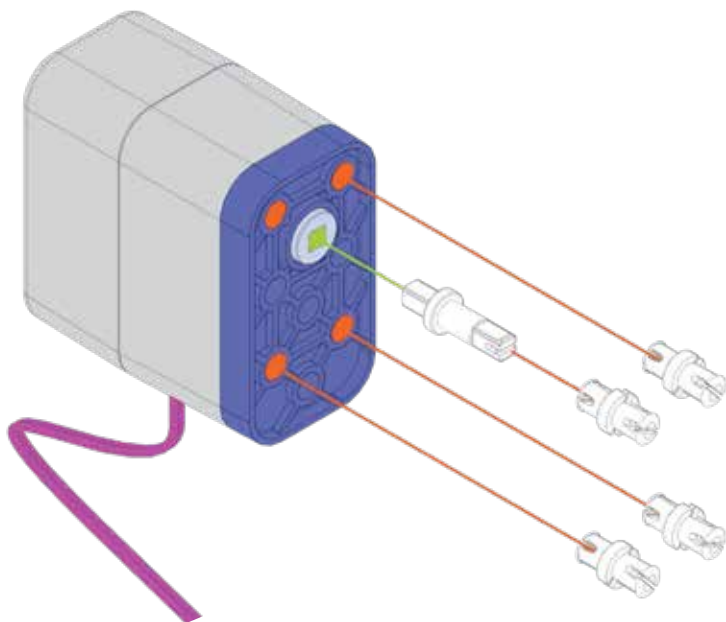

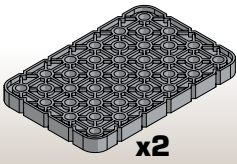

x2

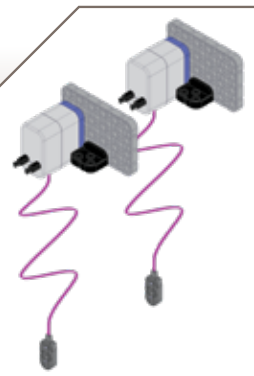

18

2x

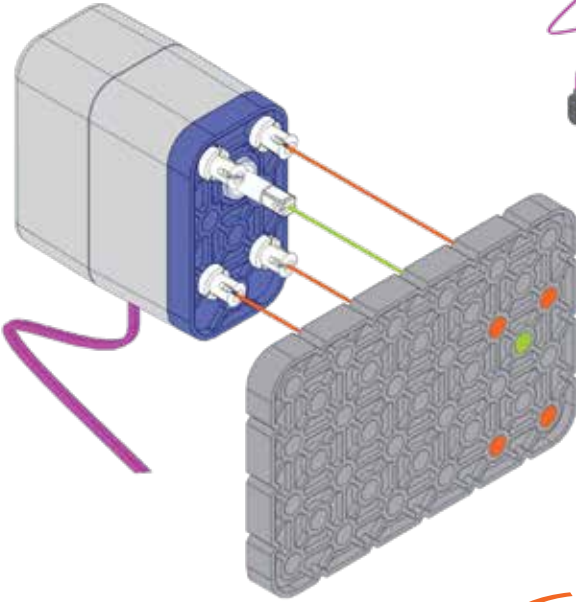

19

2x

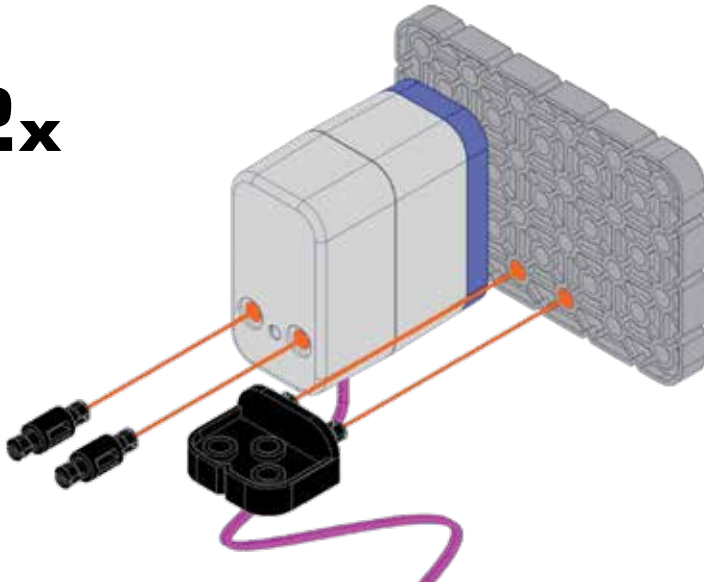

1:1

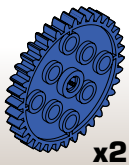

x2

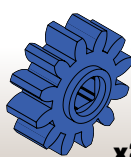

x2

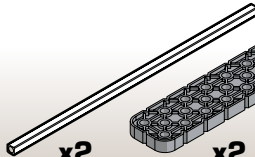

x2

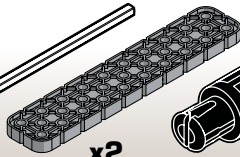

x2

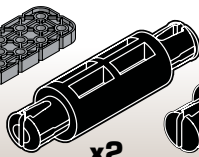

x2

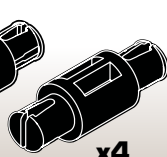

x4

20

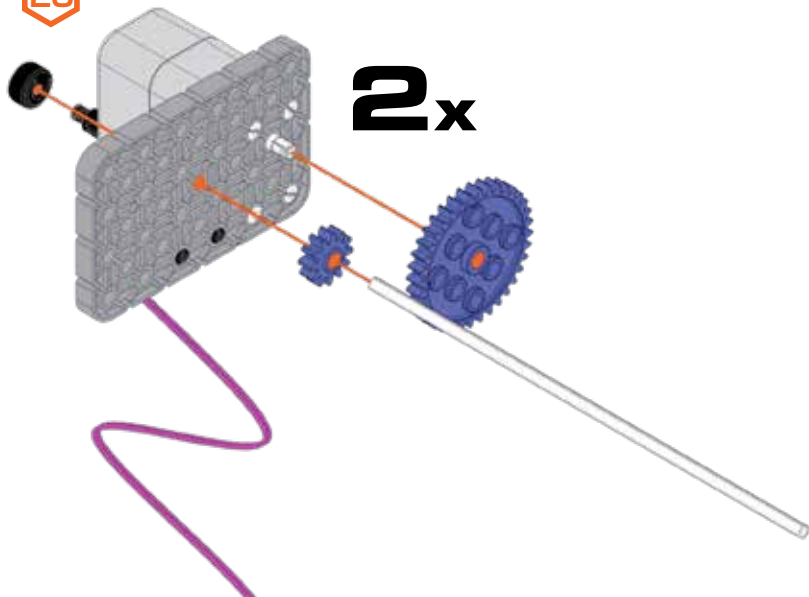

2x



1:1

21

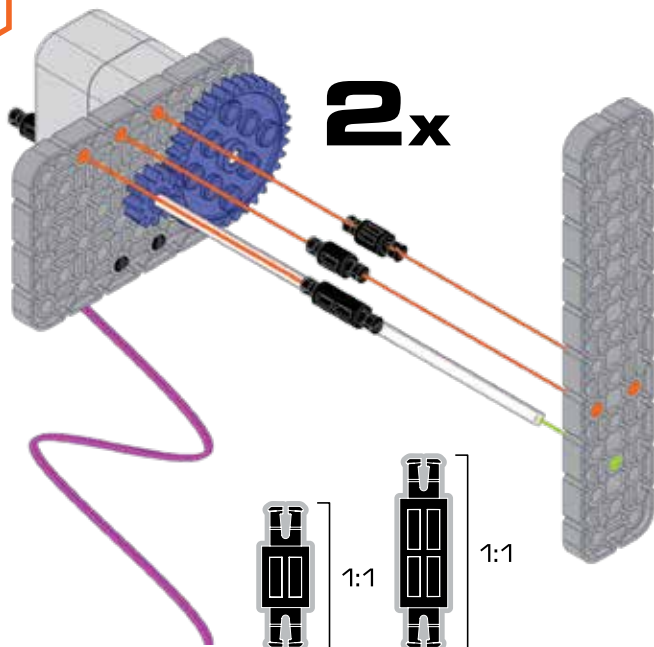

2x



1:1



1:1



x2

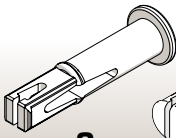

x2

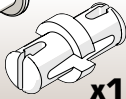

x12



x2

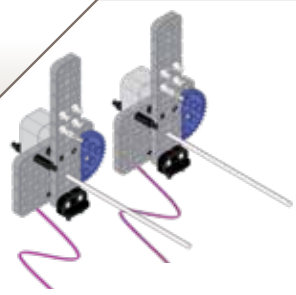

22

2x

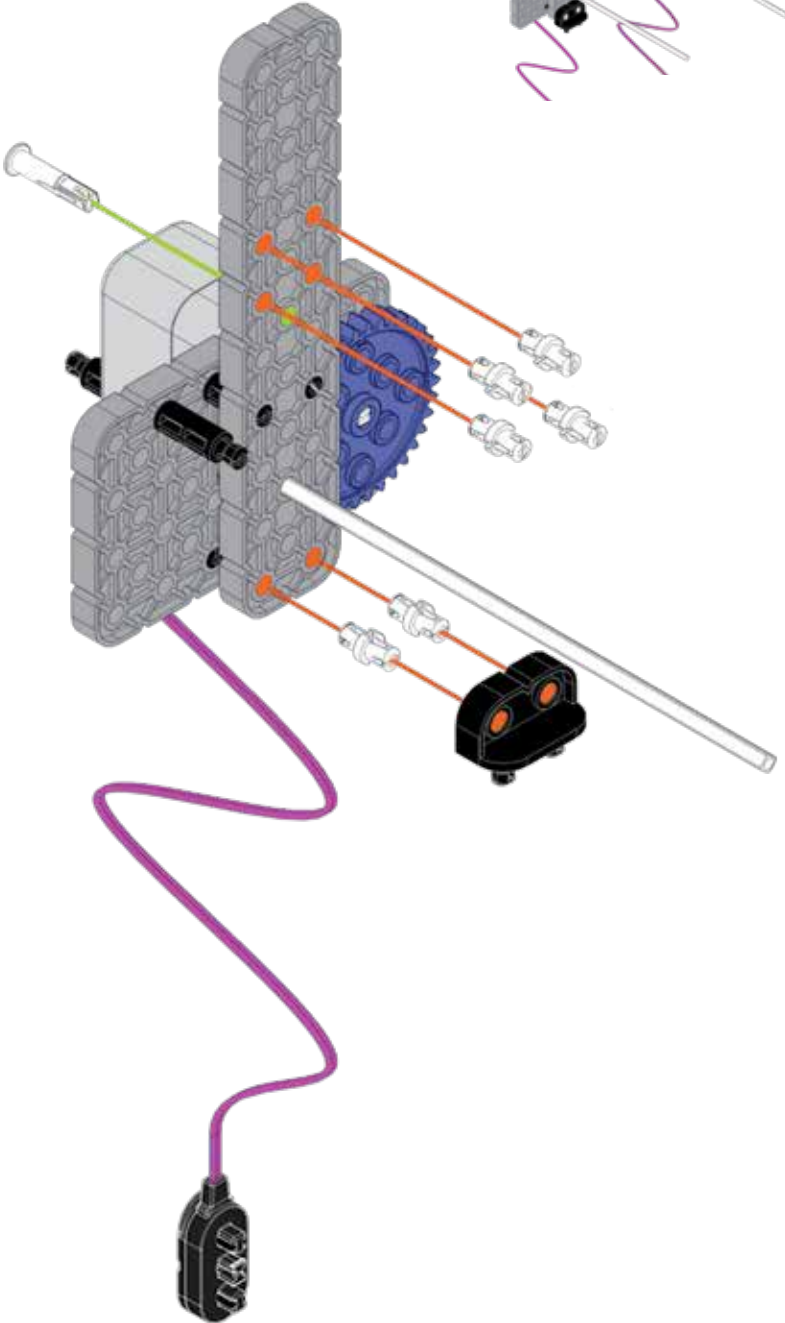

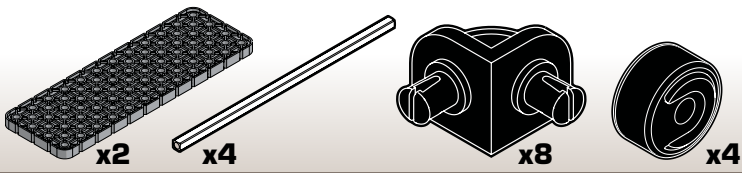

23

2x

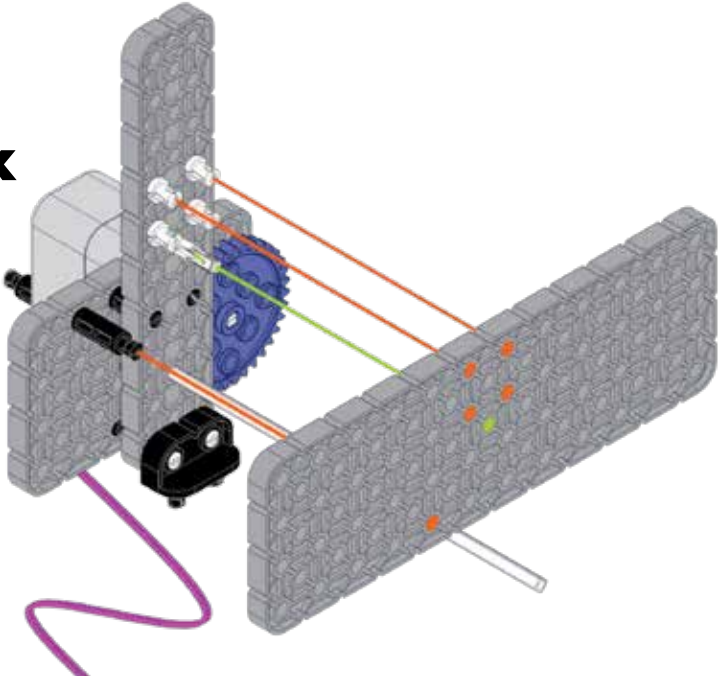

24

2x

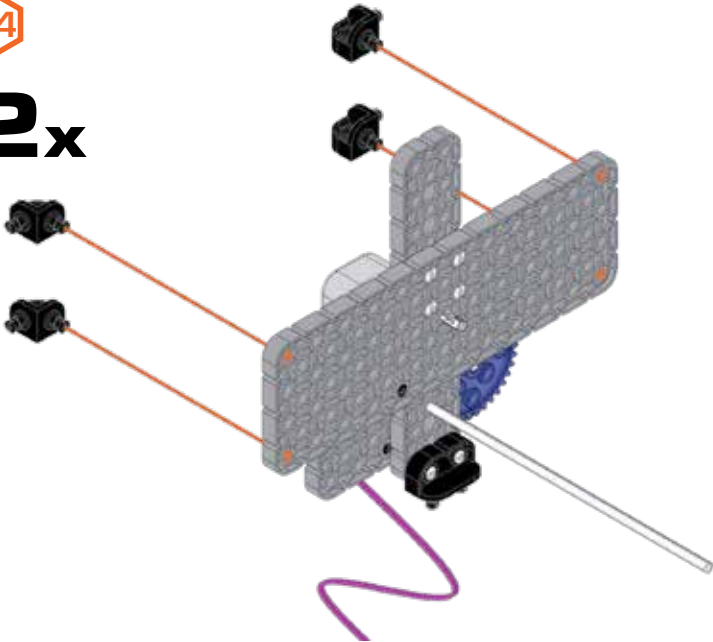





x2



x2

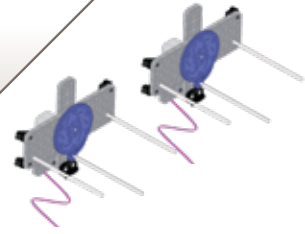

25

2x

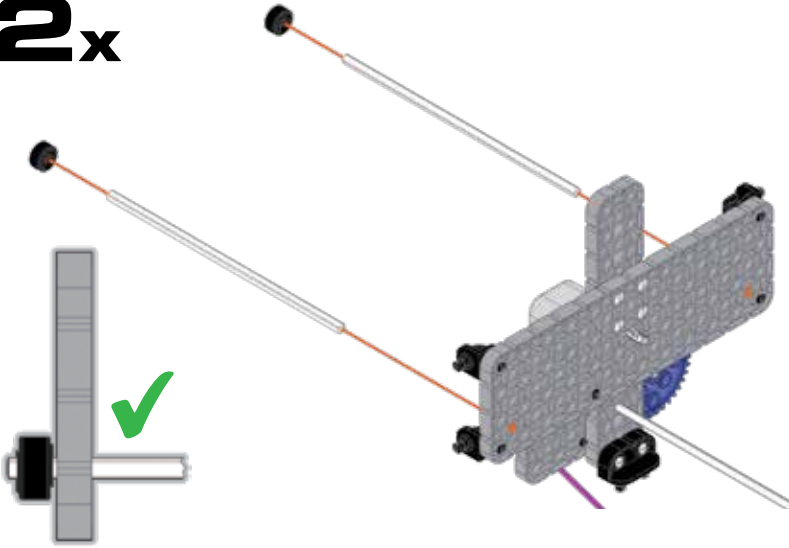

1:1

26

2x

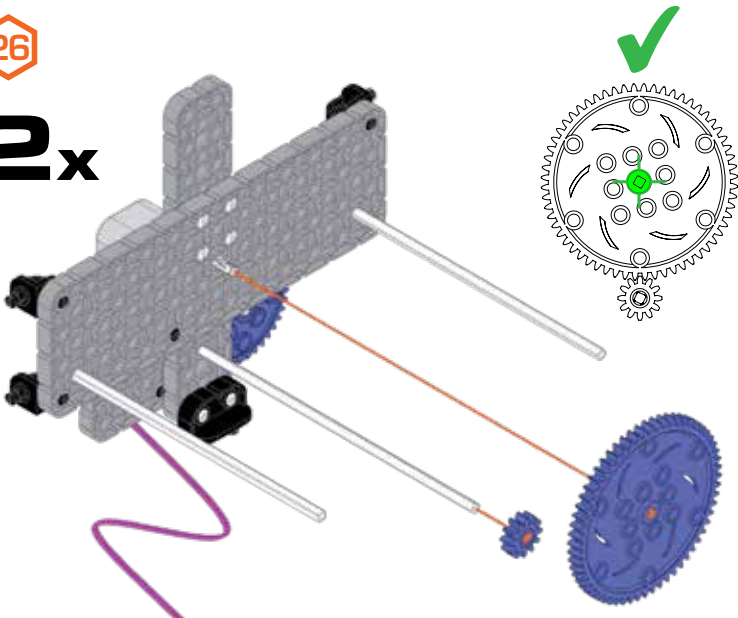

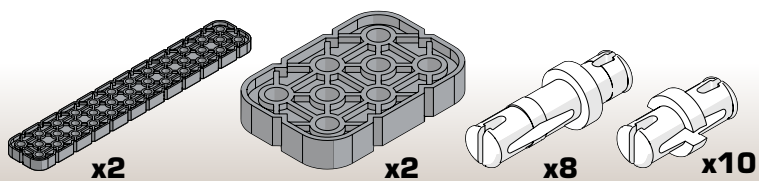

27

2x

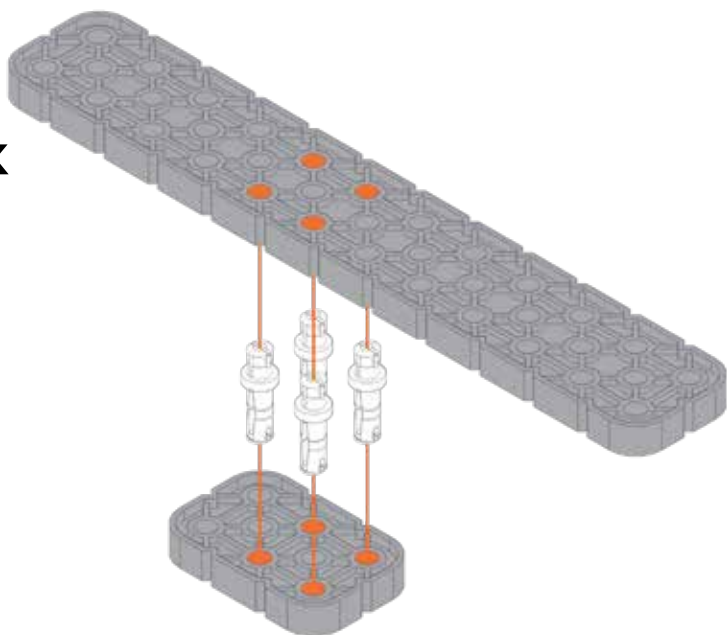

28

2x

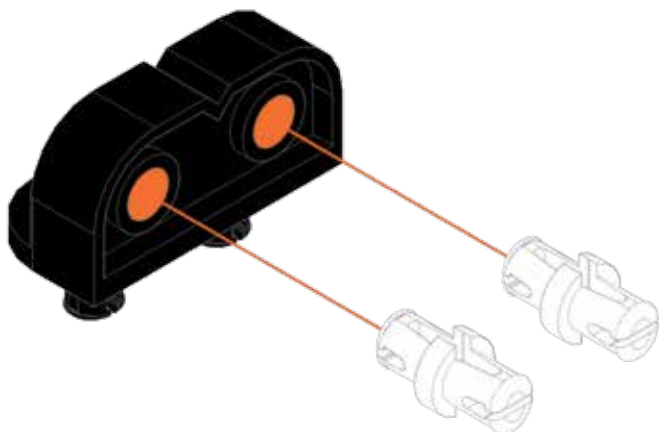

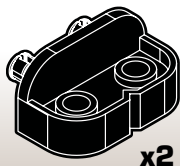

29

2x

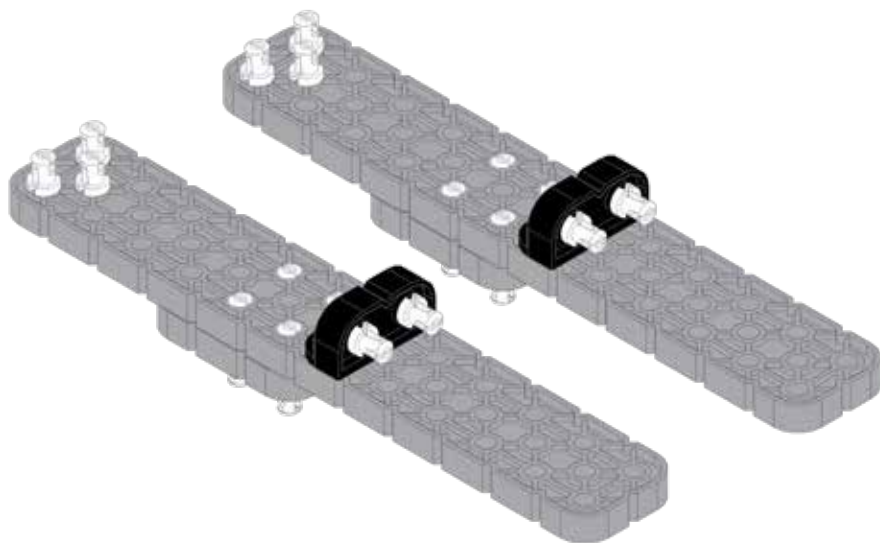
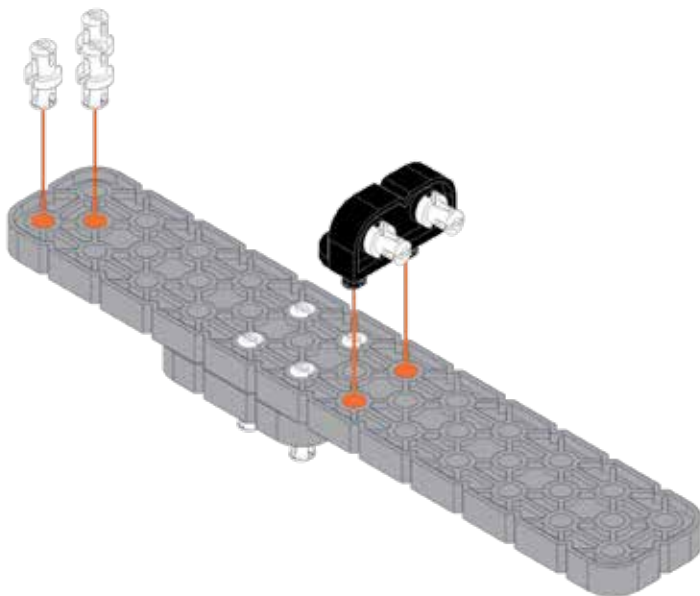

30

2x

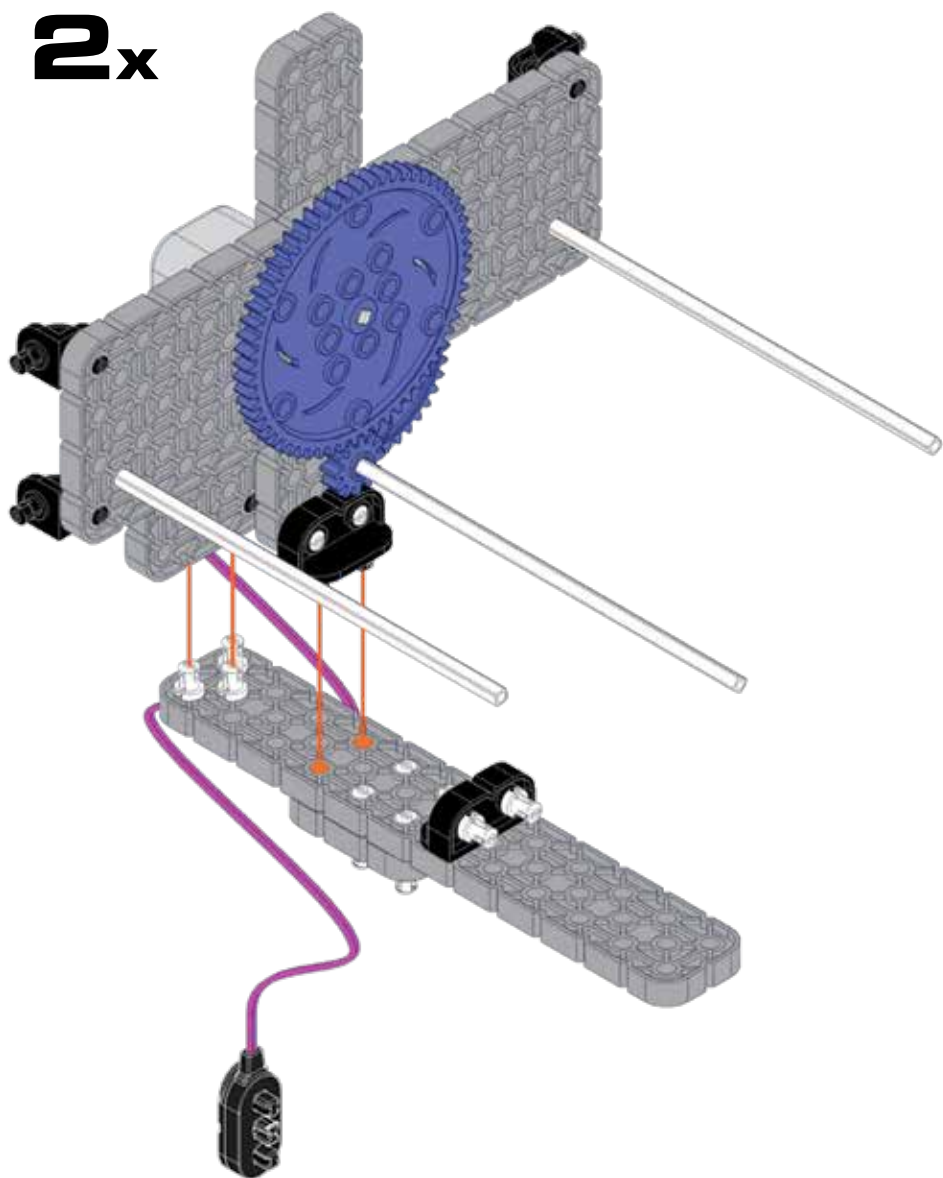

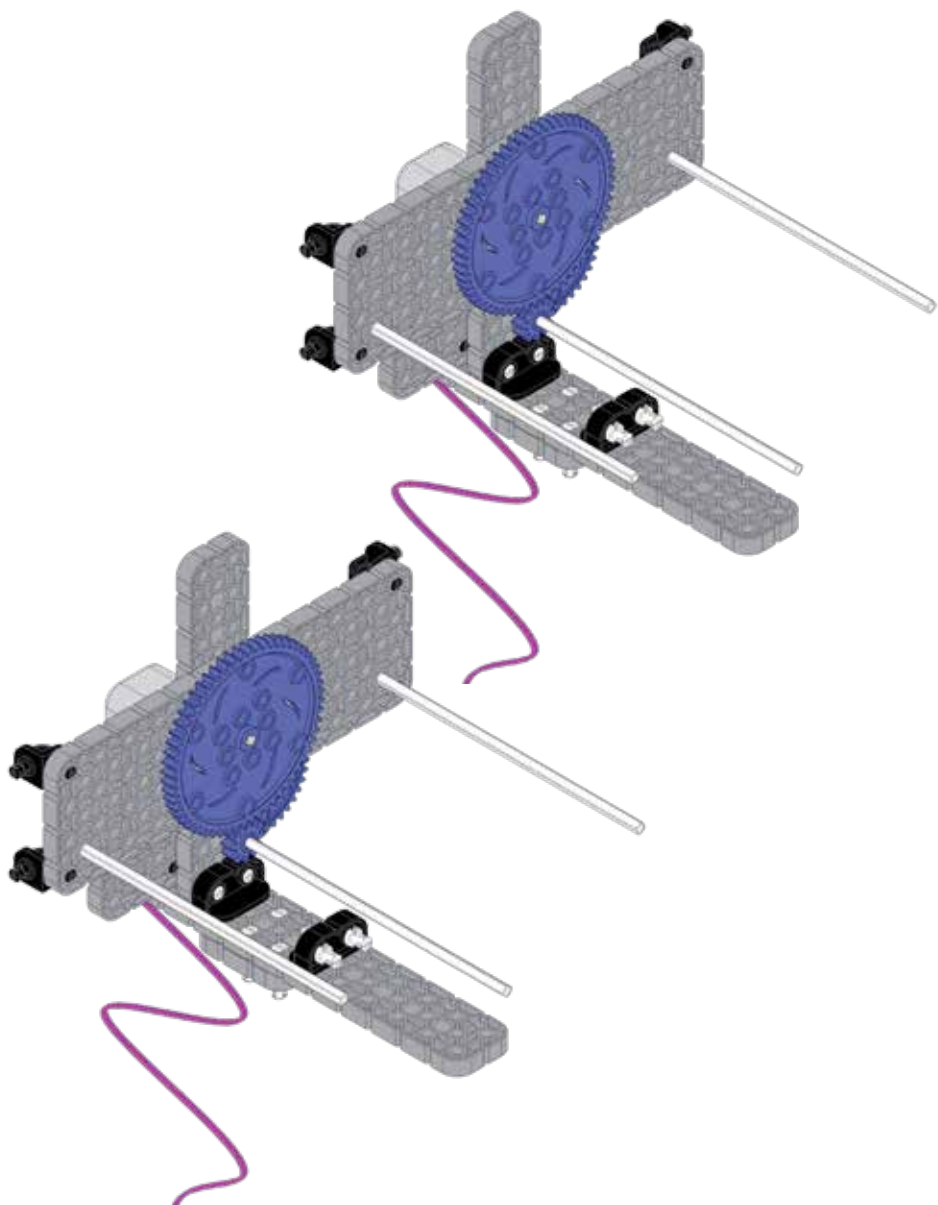

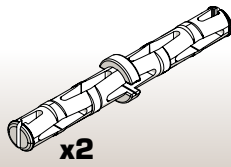
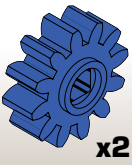

31

2x

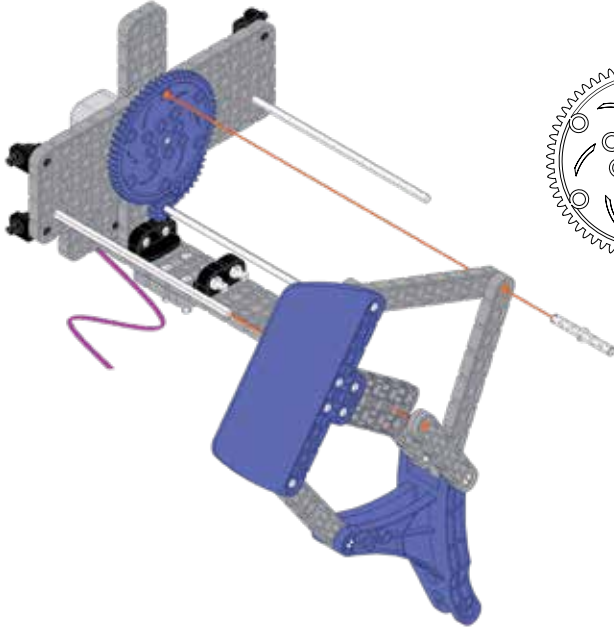

32

2x

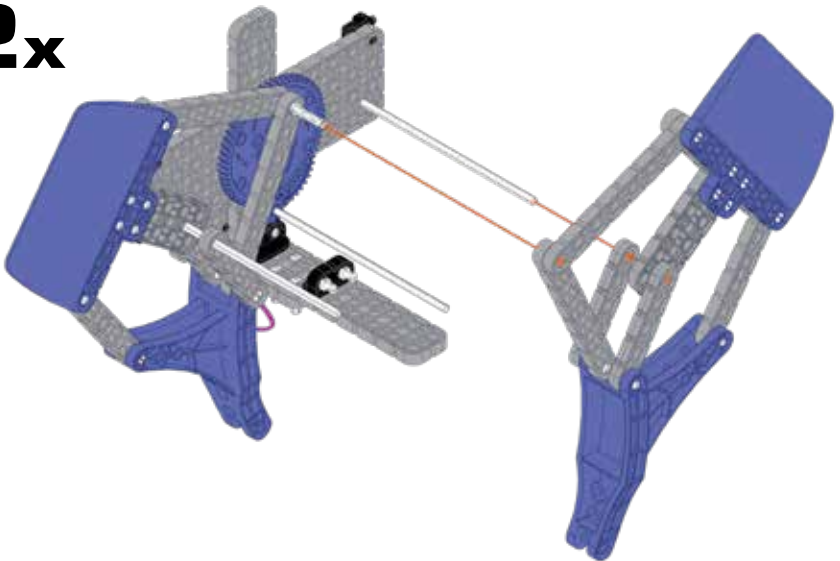

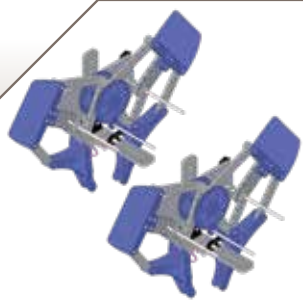

33

2x

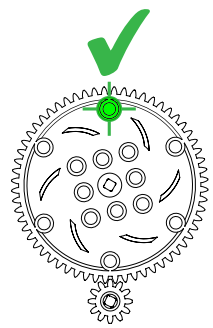
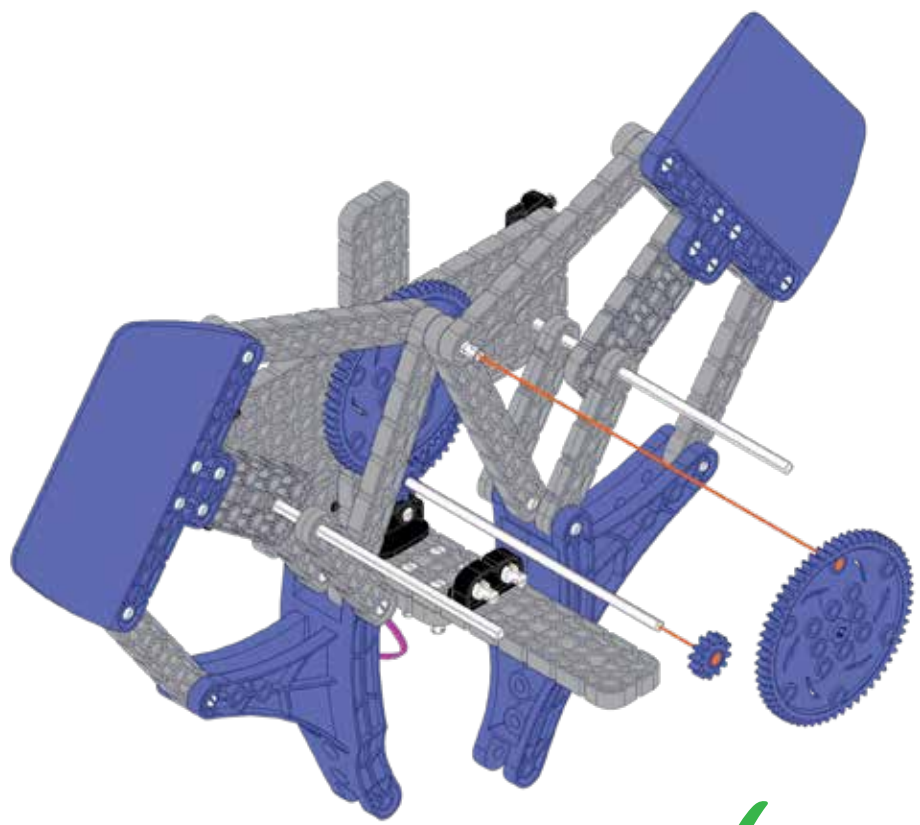

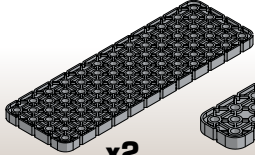

x2

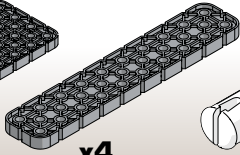

x4

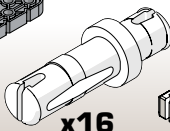

x16

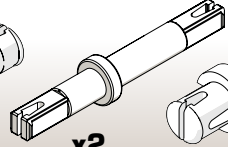

x2

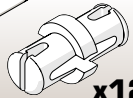

x12

34

2x

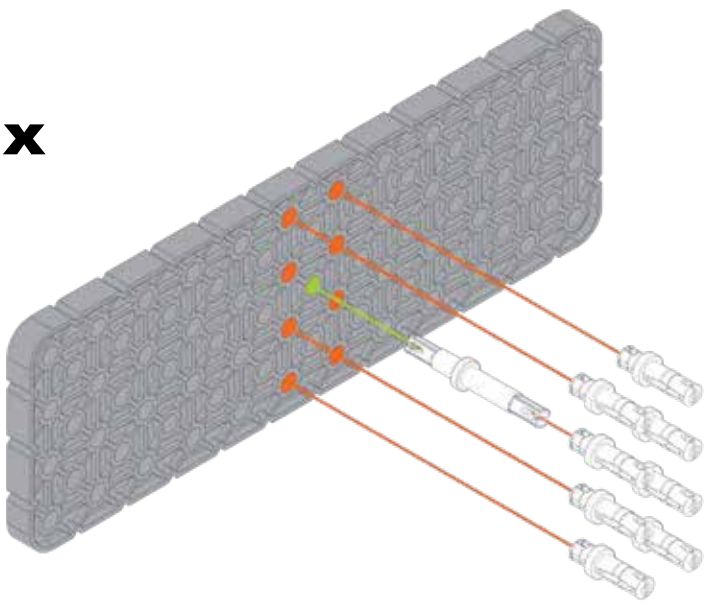

35

2x

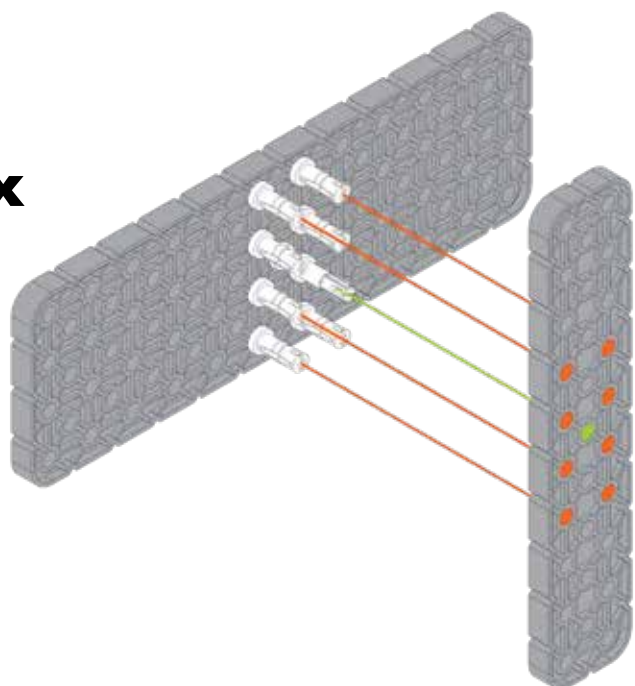



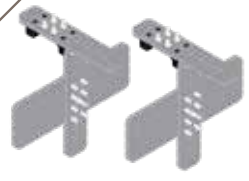
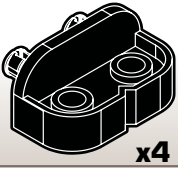

36

2x

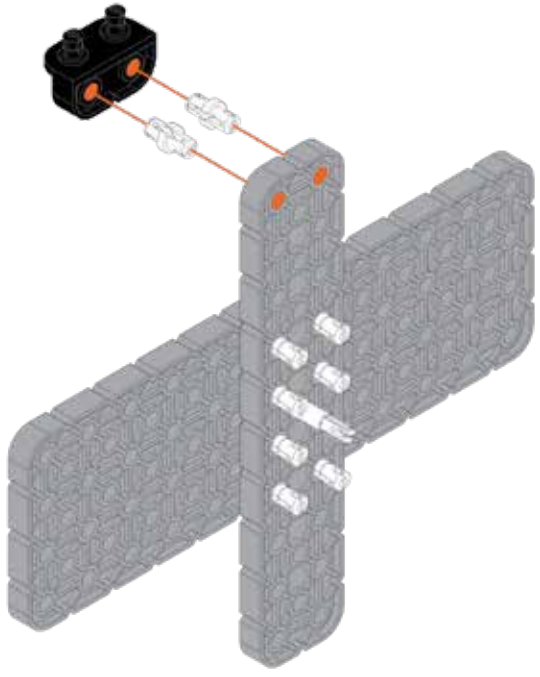

37

2x

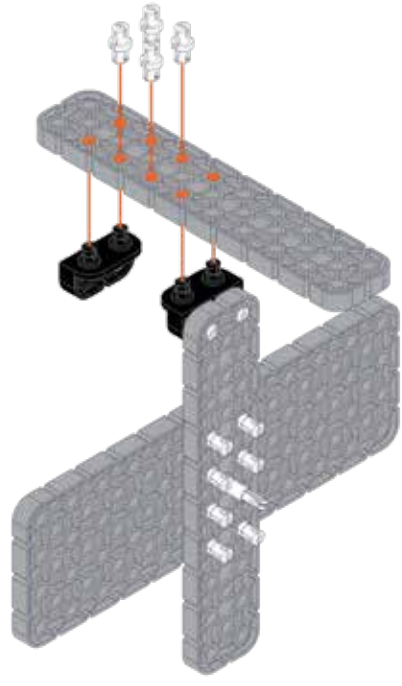

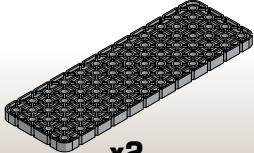

x2

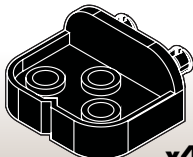

x4



x4

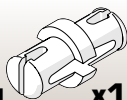

x12

38

2x

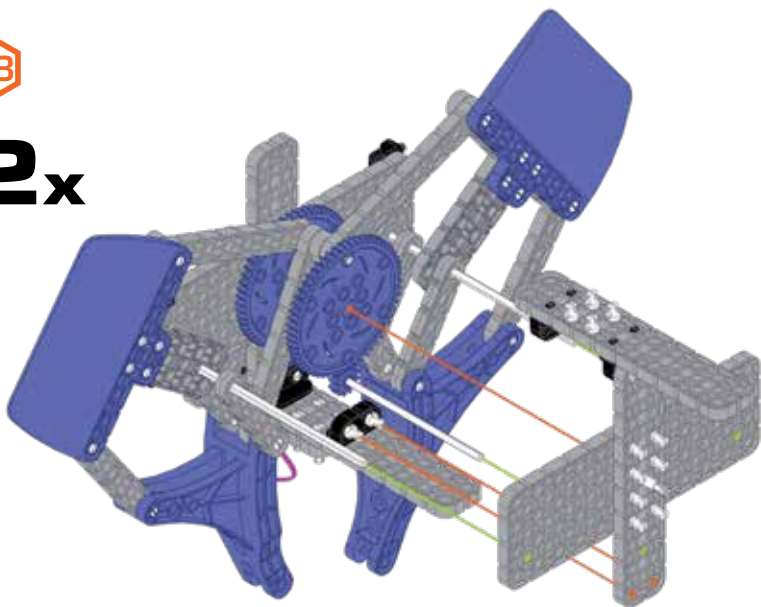

39

2x

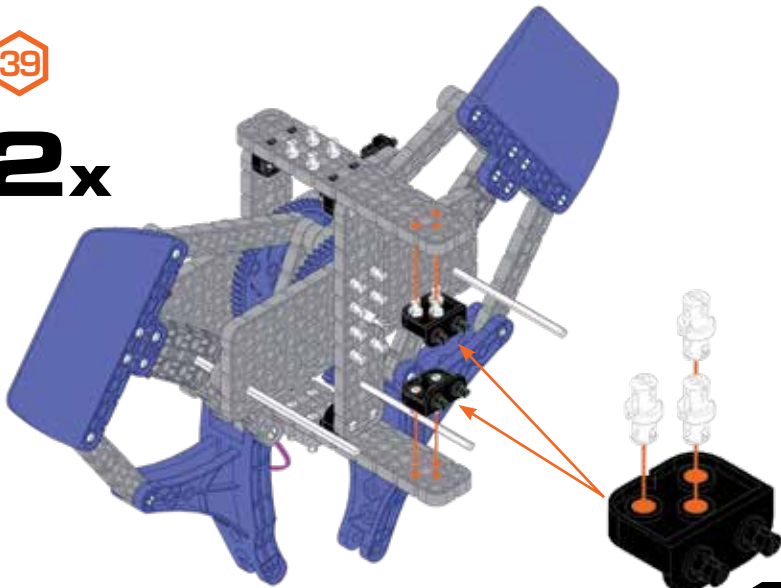

4x



40

2x

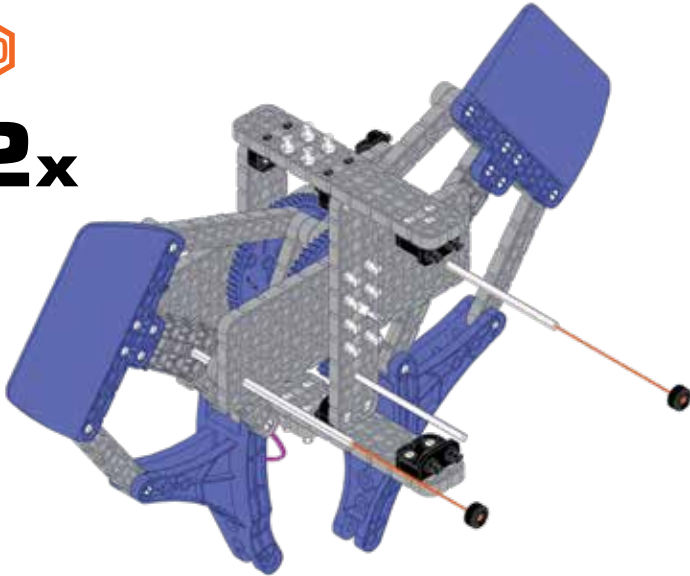

41

2x

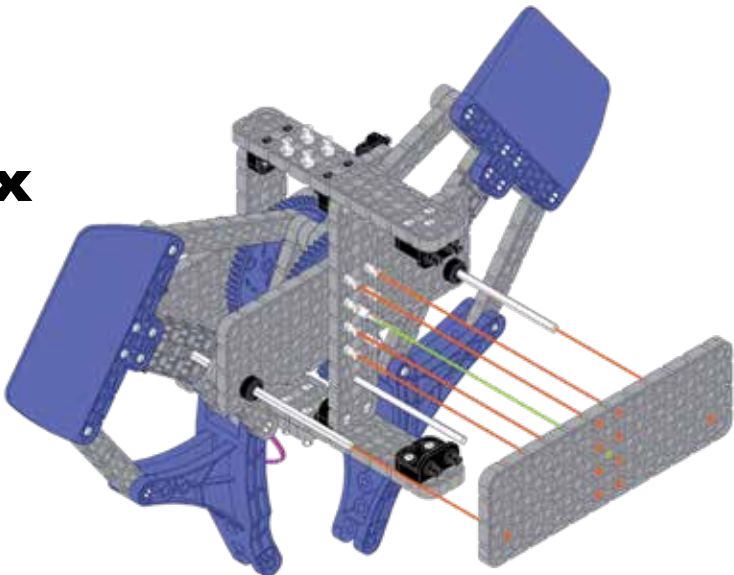

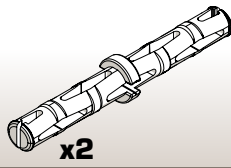
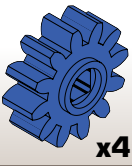

42

2x

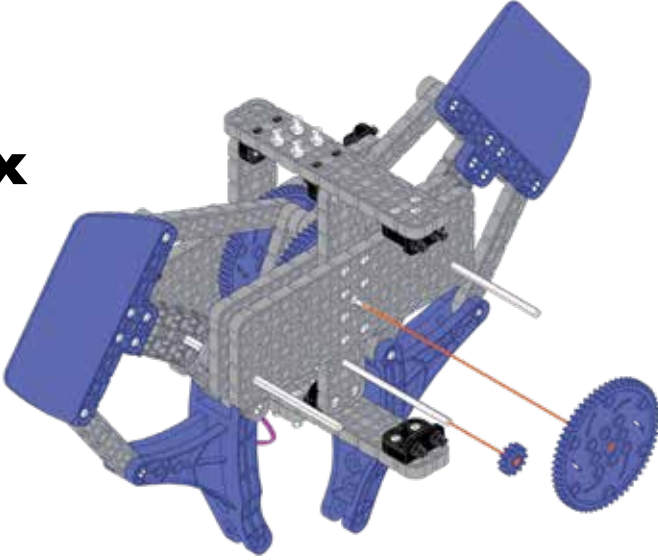

43

2x

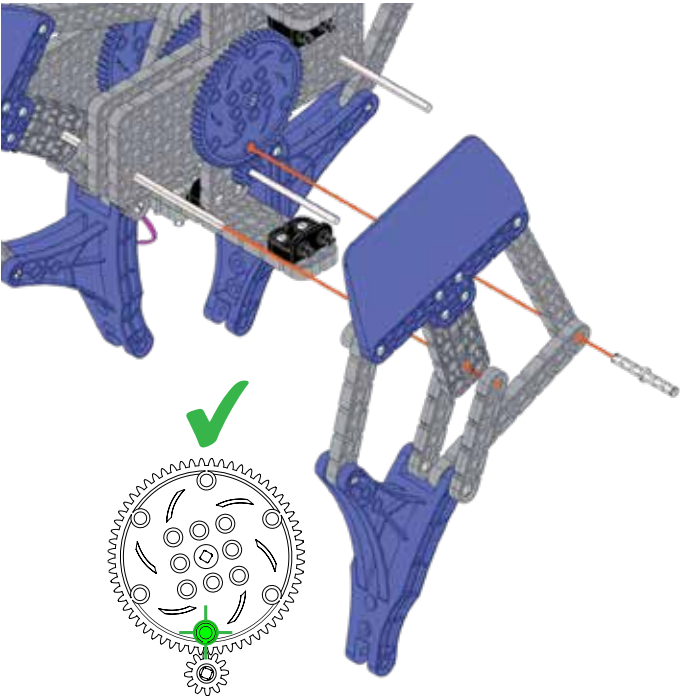

44

2x

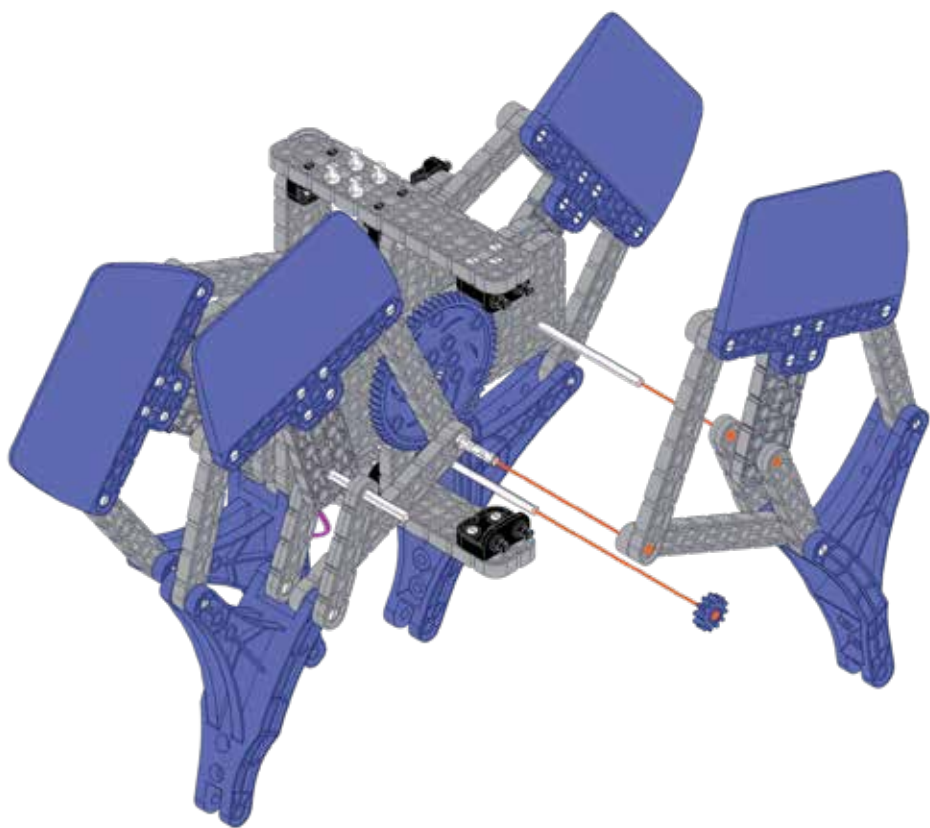
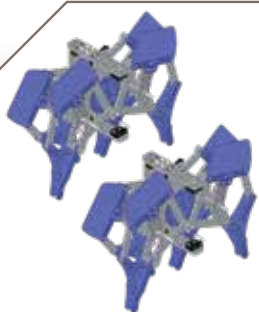

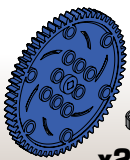

x2

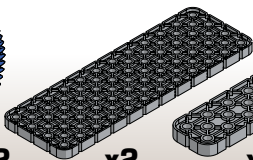

x2

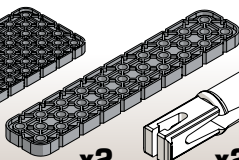

x2

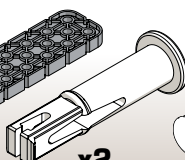

x2

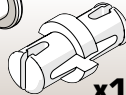

x16



x6

45

2x

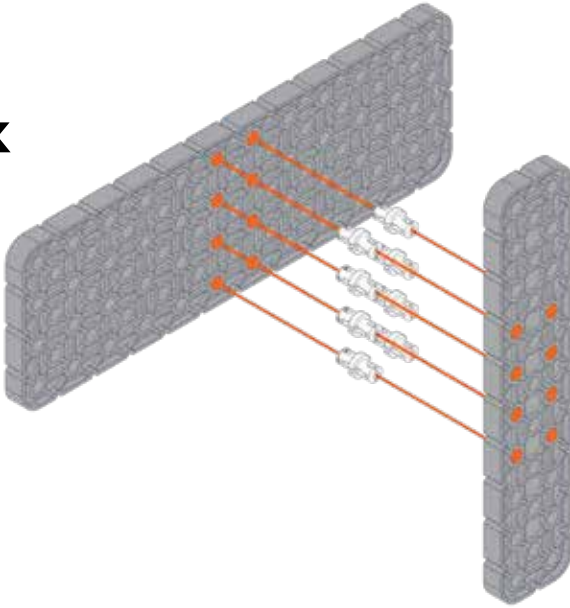

46

2x

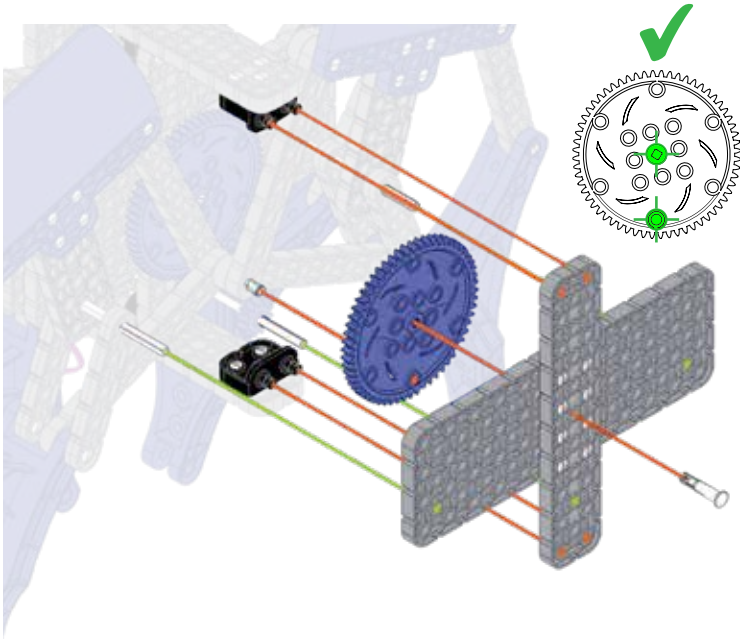

47

2x

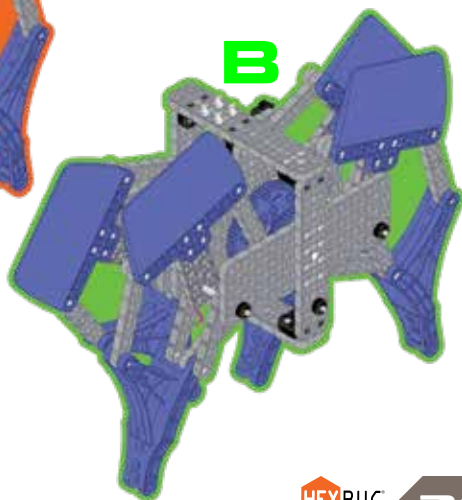
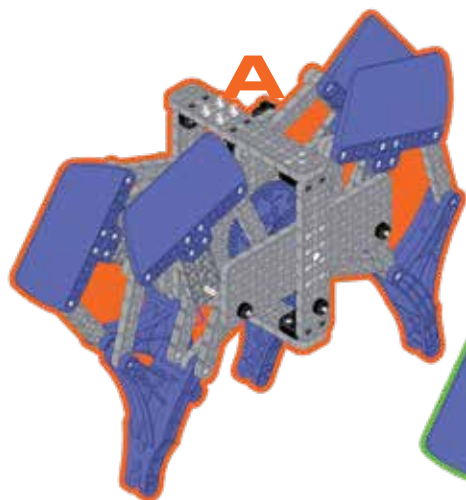
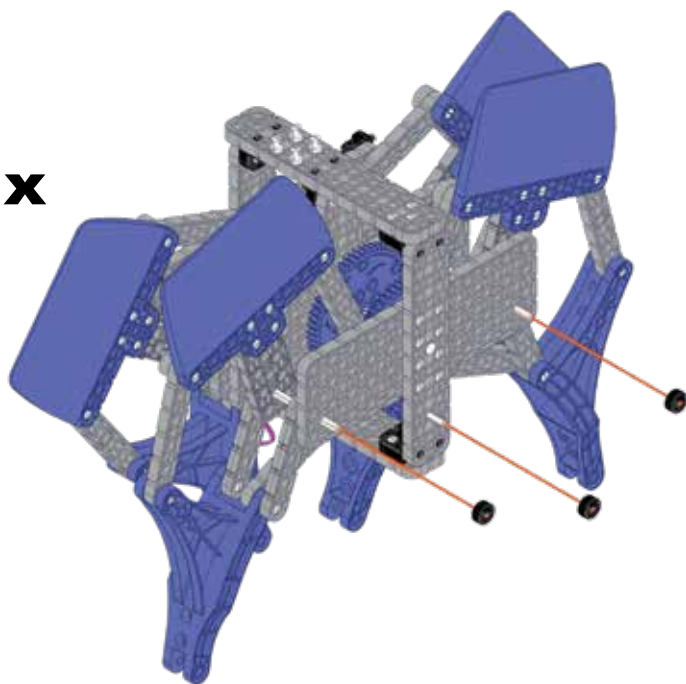

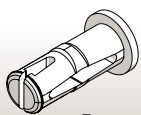

x4

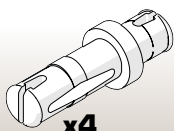

x4

48

1x

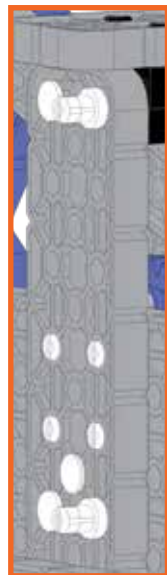
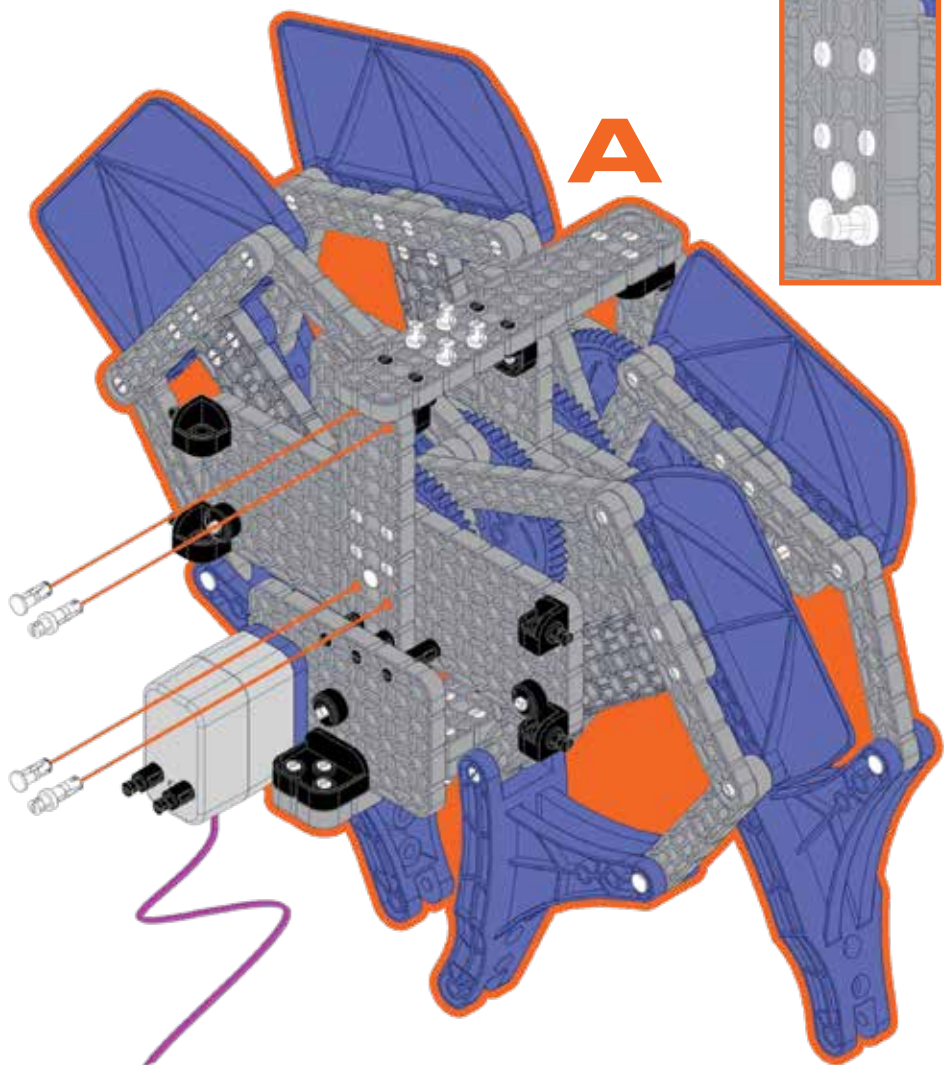



49

1x

B

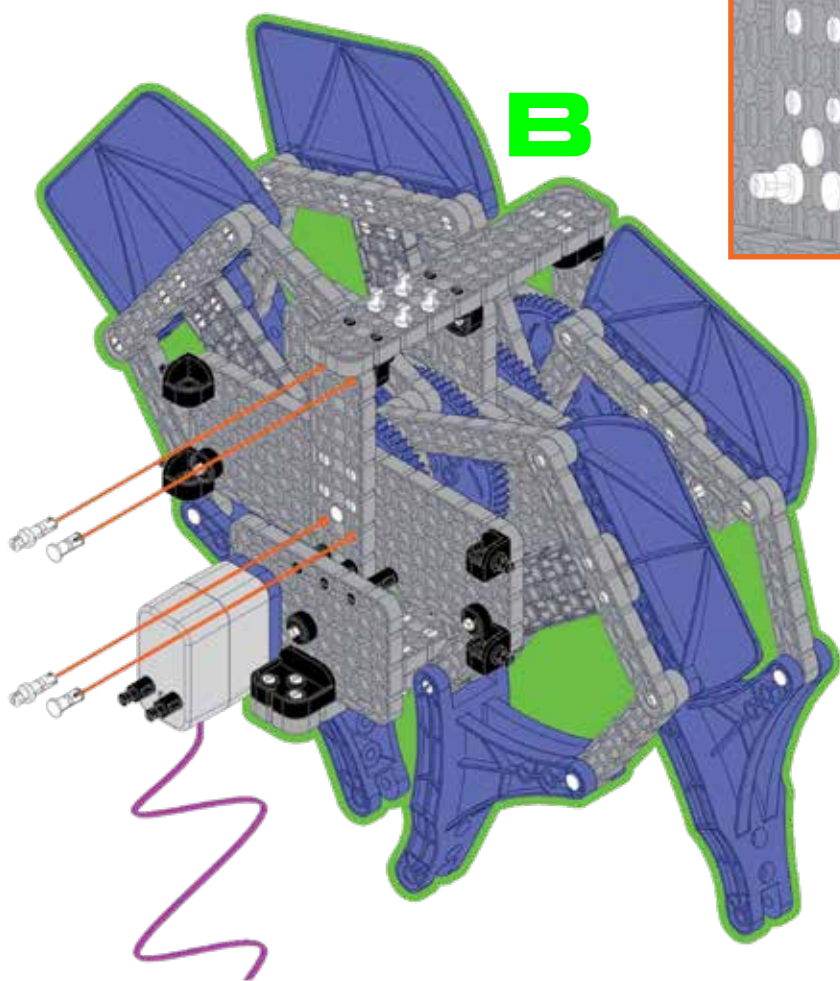
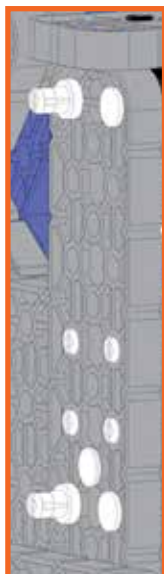

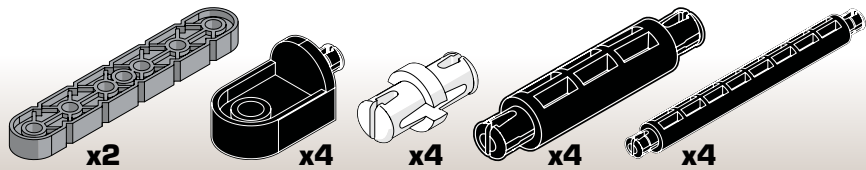

50

2x

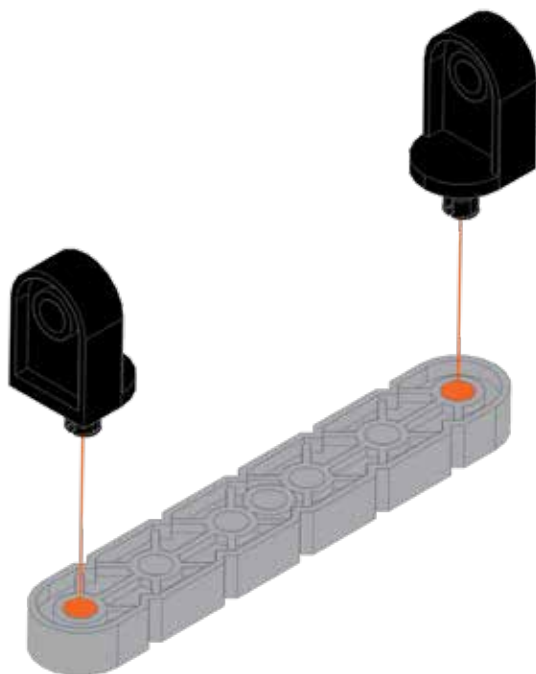

51

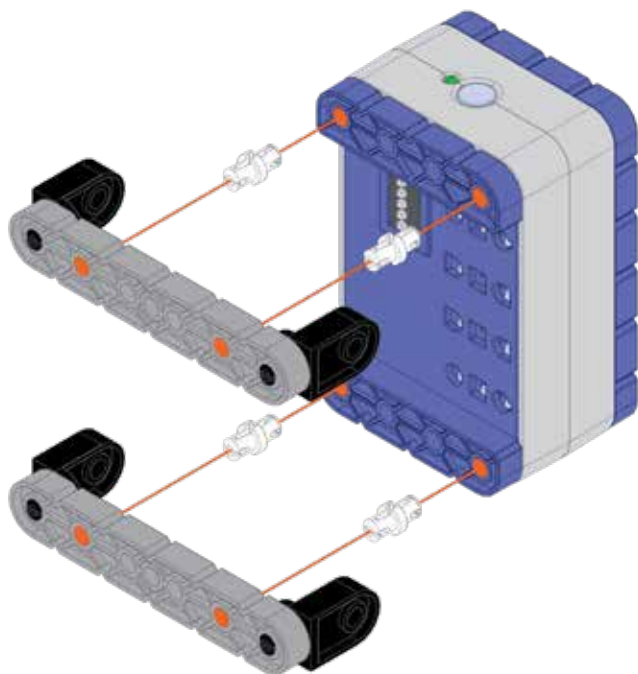

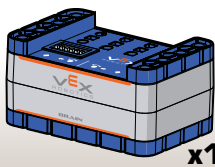

x1

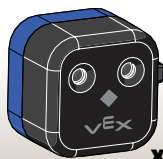

x2

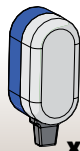

x2

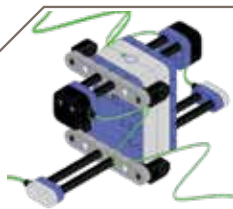

52

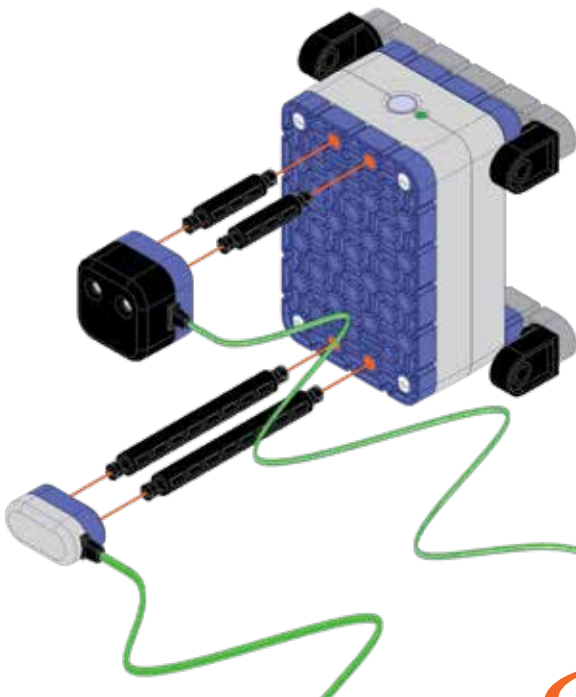

1:1

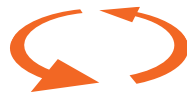

53

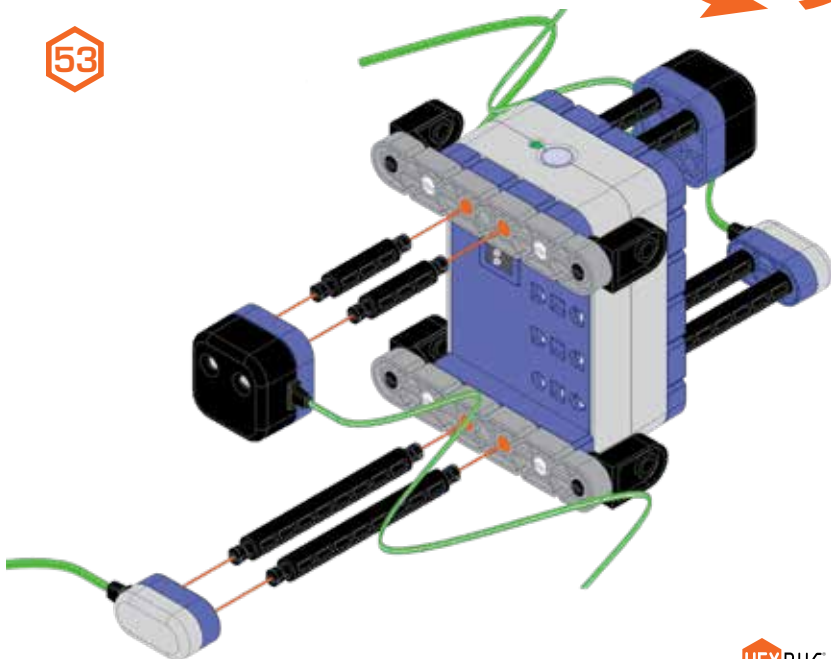

1:1

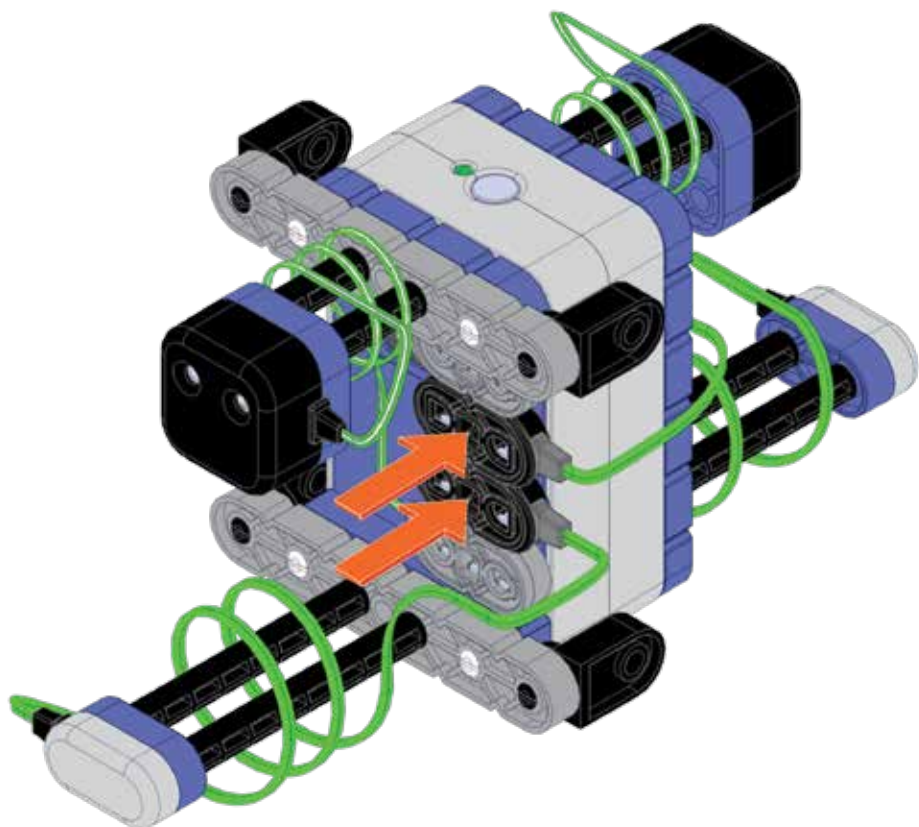

55

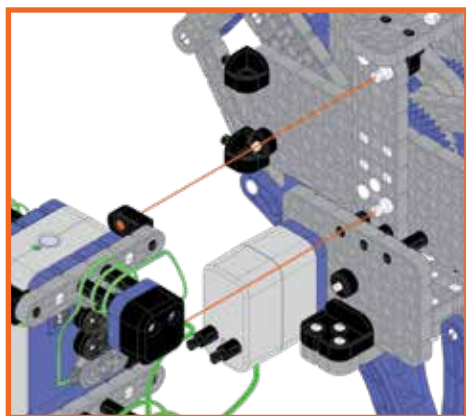
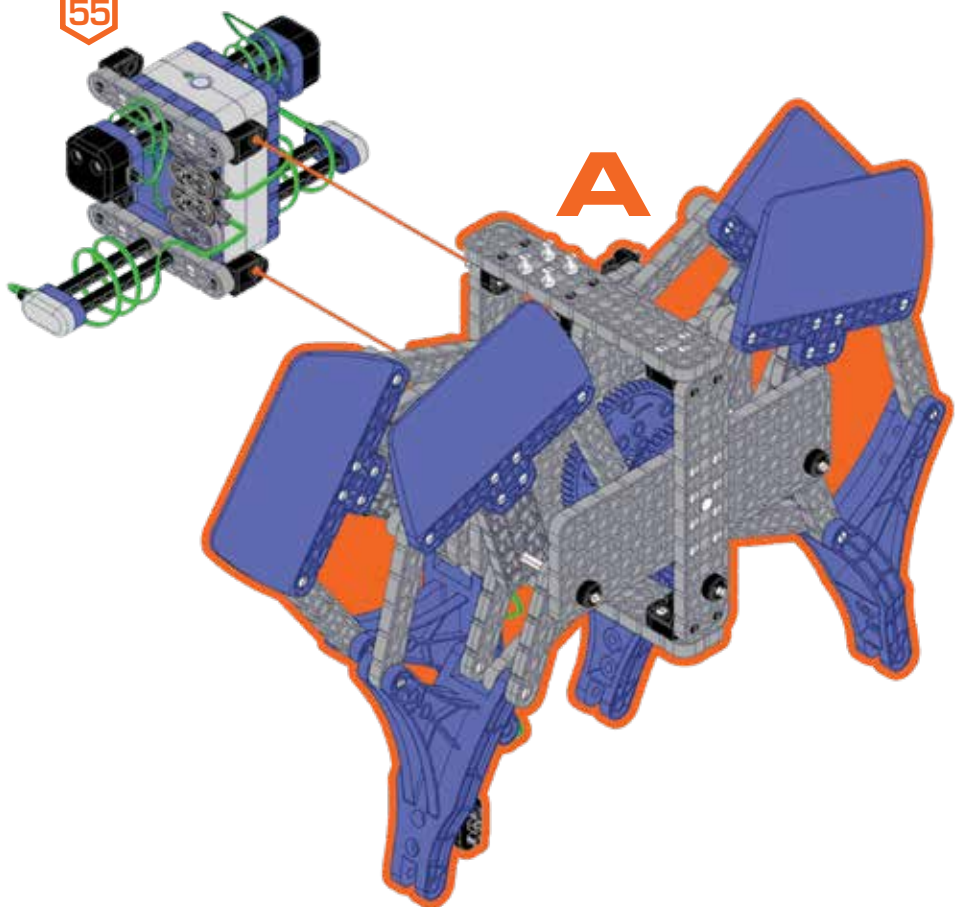

56

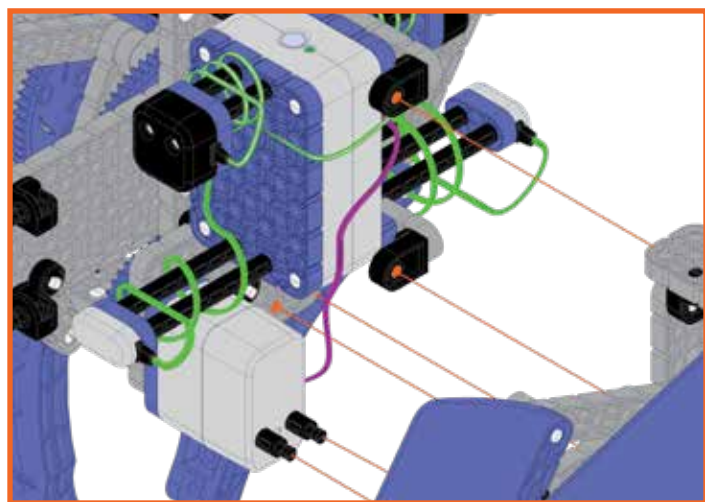
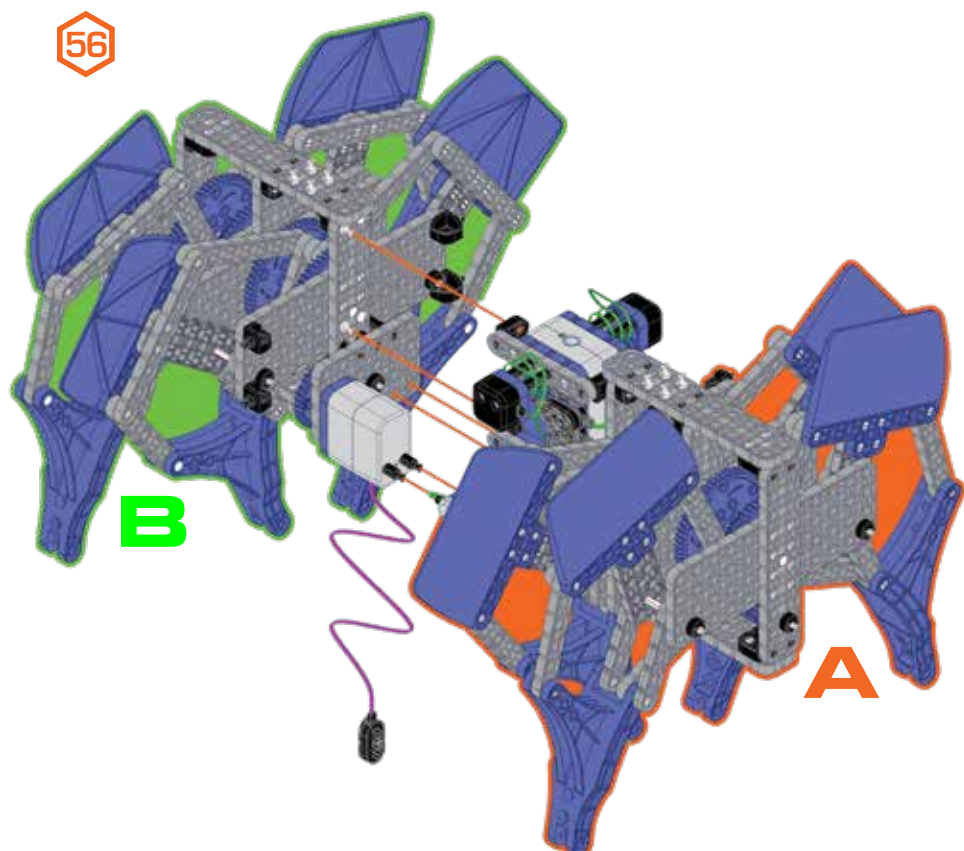

57

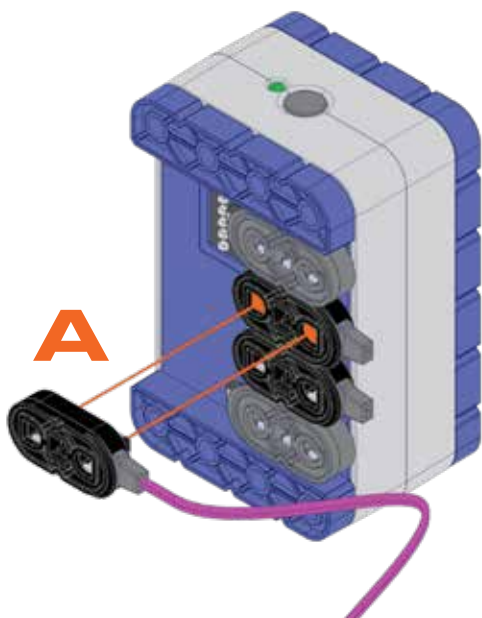

58

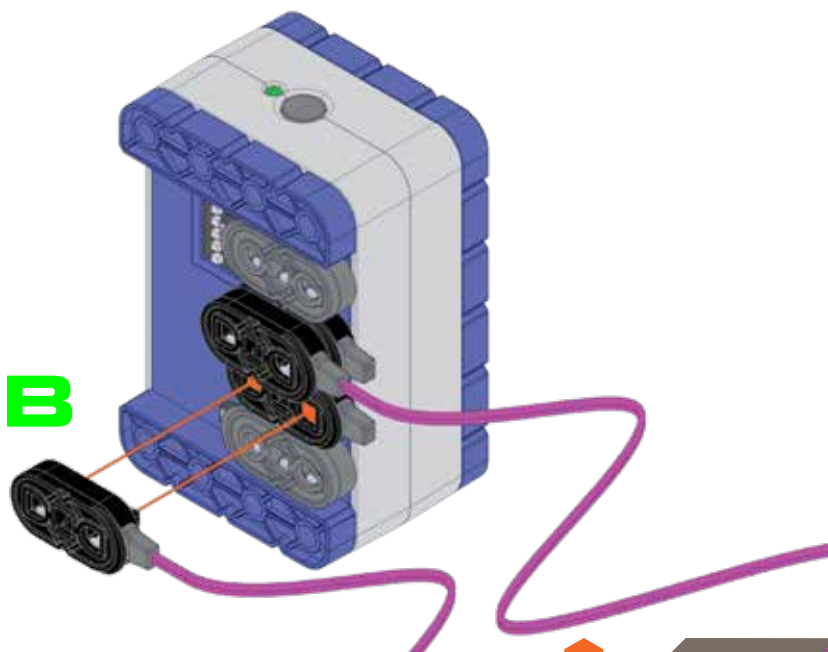

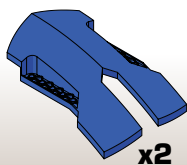

x2

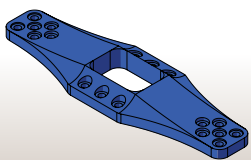

x2

59

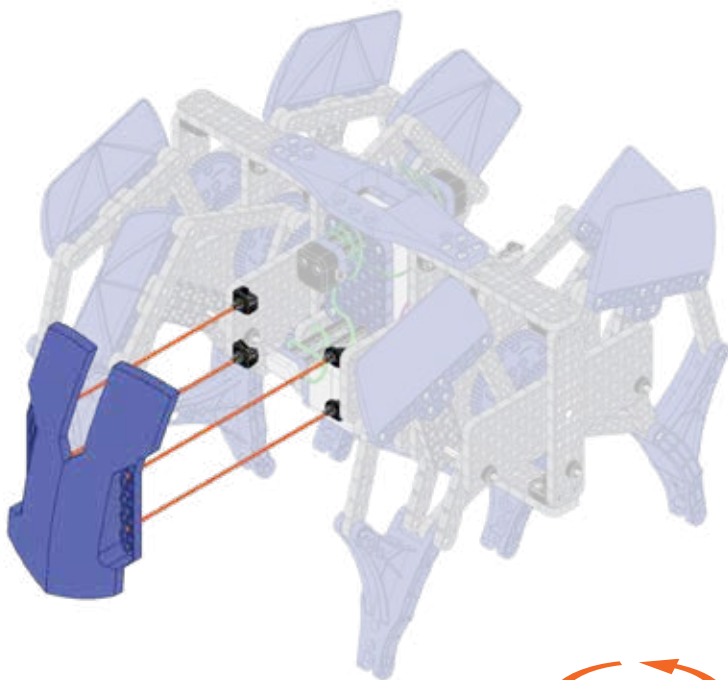

60

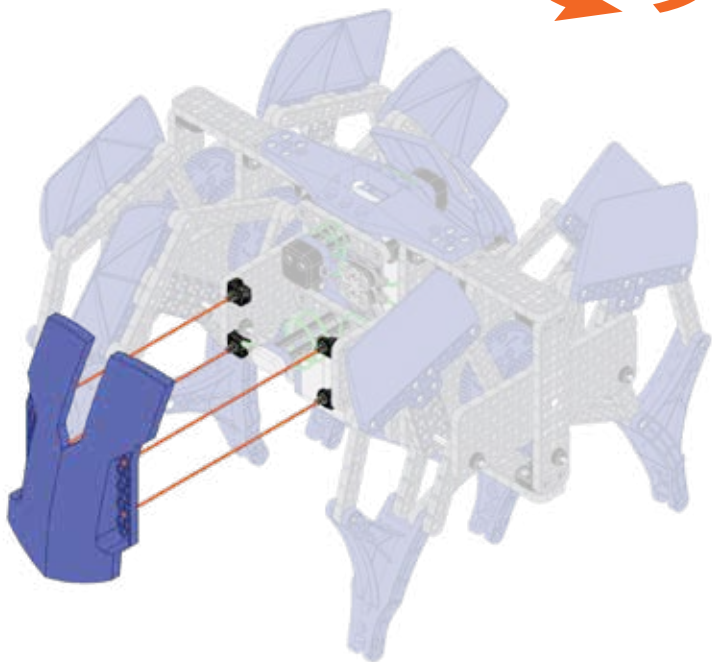



61

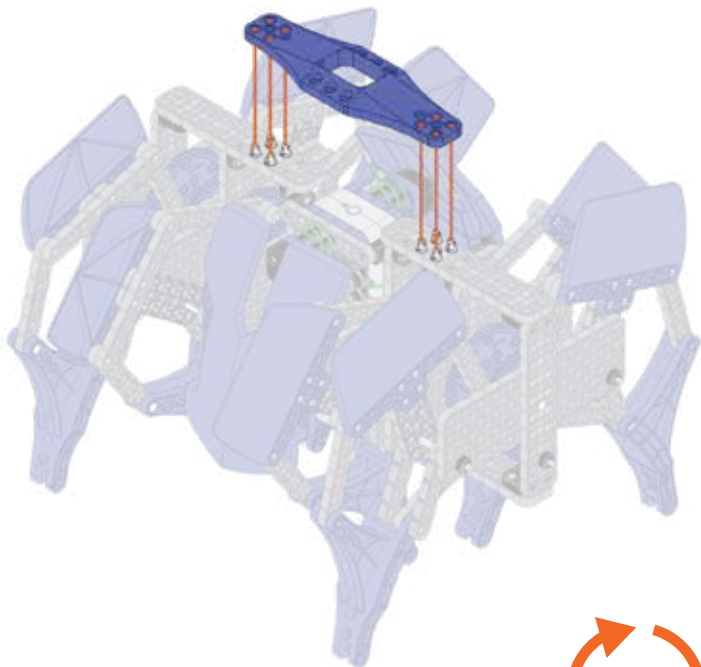

62



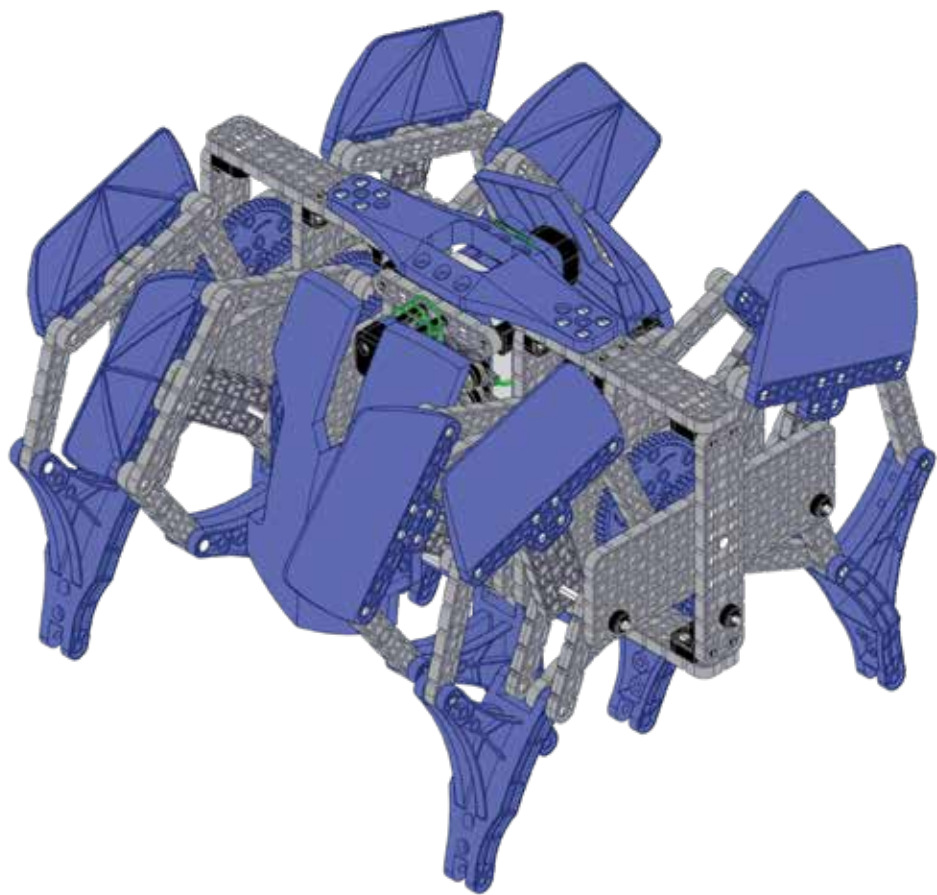

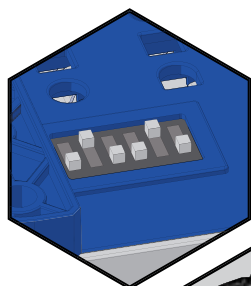

玩家可调整拨位开关来预设移动模式，当传感器被触发时，斯坦比怪兽机器人将按设定的模式进行移动。一共有64种不同编程供您选择！

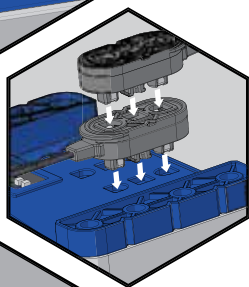

每个马达与传感器通过连接头与主控制器进行输入与输出。

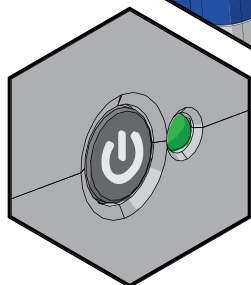

启动主控制器的时候，按左边的电源开关。关闭主控制器的时候，长按电源开关。主控制器启动后，电源开关旁的LED灯会发光！

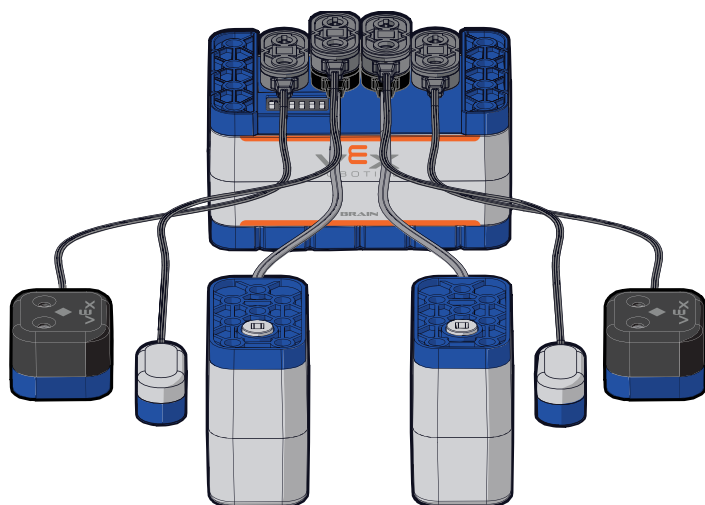



### M - 手动控制模式

- 滑动按钮开关来手动控制斯坦比怪兽前进，后退或旋转至任何方向。

### 0 - 关闭电源

- 关闭遥控器时，斯坦比怪兽机器人上的主控器也将自动关闭。



### 电源与无线开关

- 按LED灯旁的按钮启动主控制器
- 将控制器上调至M或A模式启动遥控器。
- 长按开关按钮关闭主控制器，与此同时遥控器也被关闭。
- 机器人闲置几分钟后将自动进入睡眠模式。按开关进行重启。

### A - 自动模式

- 观赏斯坦比怪兽机器人自主移动!
- 传感器可保护斯坦比怪兽机器人撞向周围的障碍物!
- 任意选择巨型斯坦比怪兽机器人的移动模式!

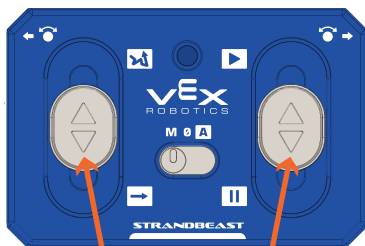

### LED灯显示颜色说明

- 绿色- 电量满格
- 红色- 电量不足
- 持续亮灯- 连接中
- 持续闪灯- 连接成功

### M 手动模式控制马达1

使用左边的按钮开关控制马达1正转或反转。



### 手动模式控制马达2

使用右边的按钮开关控制马达2正转或反转。



### A 自动模式 随机或正常移动

上下移动左边的按钮开关更改移动模式：随机或正常移动



### 自动模式 启动或停止

上下滑动右边按钮开关启动或停止斯坦比怪兽机器人。



主控制器与遥控器配对：关闭主控制器 · 启动遥控器 · 长按主控制器按钮直到LED连续闪红/绿灯 · 当LED灯闪绿灯的时候表示配对成功。

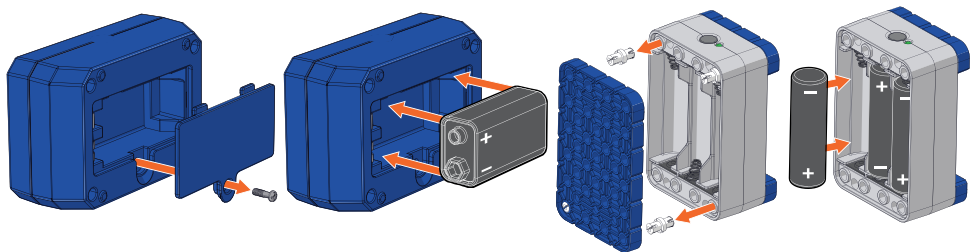

为确保儿童安全:

- 使用前, 请去除所有包装和塑料袋等(如绳子和固定带等), 并远离儿童放置, 以防窒息危险。
- 定期检查玩具完好程度。如果出现任何明显破损部件, 请停止使用, 并远离儿童放置。
- 必须在成人监护下使用玩具。

#### 安装/更换电池:

电池必须由成人来安装/更换, 更换电池时, 请佩戴安全眼镜。

- 请勿让儿童接触到电池和工具。
- 请将用尽的电池从玩具中取出以避免用尽的电池渗漏损坏玩具。
- 如电池发生泄漏, 请立刻移除并清洁电池安装槽; 如你接触到任何泄漏液体, 请立即清洗双手。
- 长时间不使用时, 请将电池取出。
- 不同类型的电池不能混用。
- 新旧电池不能混用。
- 丢弃玩具时请先移出电池。
- 请勿焚烧电池, 或随意丢弃废旧电池。请将废旧电池放置在指定回收地点。
- 请勿将碱性电池、标准电池或充电电池混用。
- 电源端子不得短路并且注意“+”“-”极性。
- 请勿为非充电电池充电, 可能引起爆炸。
- 充电电池只能在成人监督下充电。
- 如果使用充电电池, 在充电前请从玩具中移除。

电池内含腐蚀性化学物质, 一旦进入体内会导致身体严重伤害, 需立即寻求医生帮助。

#### 产品的清洁与维护:

用拧干的柔软湿布清洁玩具表面。不要使用洗涤剂或化学溶剂清洁玩具, 防止损毁电路。

不使用产品时, 勿将产品放置在高温、沙尘、潮湿处或水中。请勿自行维修或者改装产品。



赫宝®是创首国际的注册商标, 图片仅供参考。  
请拆除所有包装后再给孩子们, 并请保留包装备用。  
本产品符合安全要求。专利: 创首国际  
中国制造与组装



使用前请仔细阅读说明书, 并妥善保管。



赫宝官方微信





# VEX<sup>®</sup>

## ROBOTICS

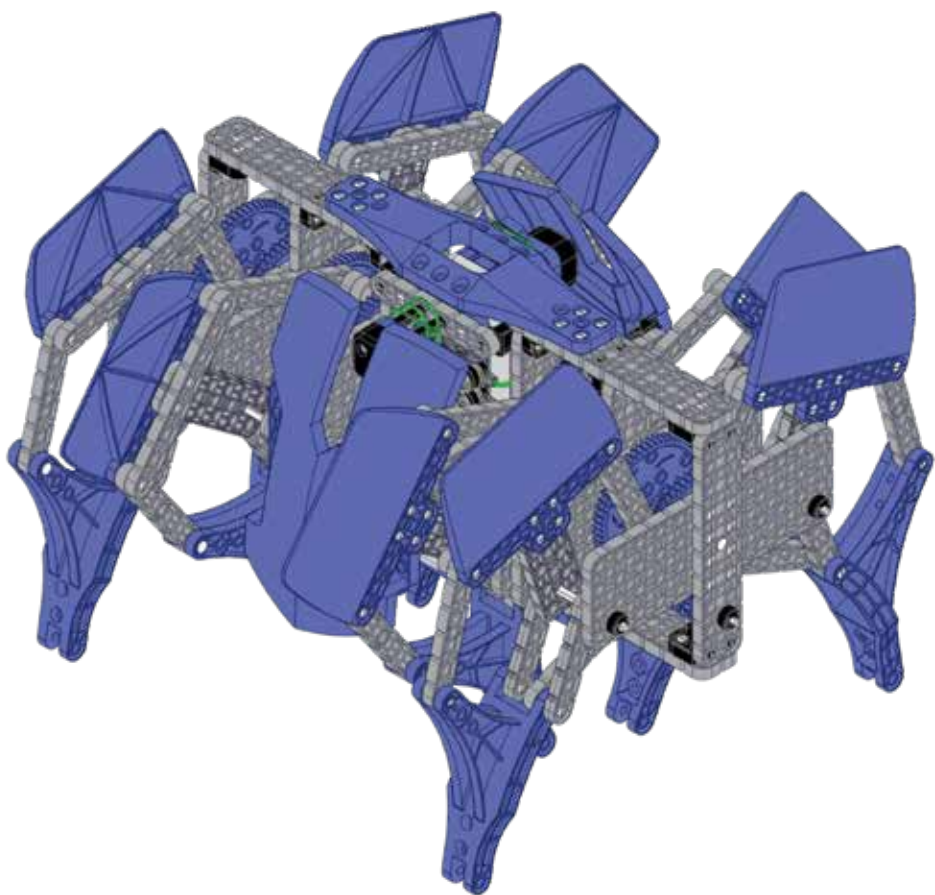

欢迎登陆[WWW.HEXBUGVEX.COM](http://WWW.HEXBUGVEX.COM) 查看最新组装说明!